

# Cable Glands

Standard Cable Glands, Polyamide with Threads, with Locknut



### Polyamide cable glands with lamellar clamping

- For standard industrial applications
- Material: Body, Cap: PA 6 / Seal: CR
- Ingress Protection Rating: IP68 - 5 Bar, 30 min / IP 66
- UL Environmental Rating: TYPE 1, 4X acc. to UL 50E
- Flammability: V2 according to UL94
- Operating temperature:
  - Permanent: -20 °C to +100 °C
  - Intermittent: -30 °C to +150 °C
- Cable type: Non armoured
- Accessories (refers to dedicated page): Locknut (included), Washer Gaskets, Dome Plugs

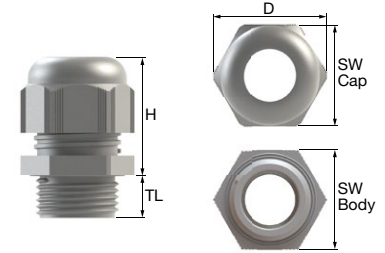

### Thread Type METRIC acc. to EN 60423

Outer Thread Size (Male)	Clamping Range Ø min - max	Outer Thread Length		Spanner Width		Outer Ø		Max. Height	Light grey RAL 7035		Grey RAL 7001		Black RAL 9005		Pkg					
		TL	mm	in	Cap	Body	D		H	Description	Part Number	Description	Part Number	Description		Part Number	per Box			
M16x1.5	2-6 0.079-0.236	8	0.315	19	19	21.7	27.4	0.394	0.748	0.854	1.079	EP-SGL-M16-LGR-A	1SNG626001R0000	EP-SGL-M16-GR-A	1SNG626002R0000	EP-SGL-M16-BL-A	1SNG626003R0000	50		
		10	0.394	0.748	0.748	21.7	27.4					EP-SGL-M16-LGR-B	1SNG626004R0000	EP-SGL-M16-GR-B	1SNG626005R0000	EP-SGL-M16-BL-B	1SNG626006R0000	50		
		15	0.591	0.748	0.748	21.7	27.4					EP-SGL-M16-LGR-C	1SNG626007R0000	EP-SGL-M16-GR-C	1SNG626008R0000	EP-SGL-M16-BL-C	1SNG626009R0000	50		
	3-7 0.118-0.276	10	0.394	22	22	25	32.2	0.591	0.866	0.984	1.268	EP-SGL-M16-LGR-D	1SNG626010R0000	EP-SGL-M16-GR-D	1SNG626011R0000	EP-SGL-M16-BL-D	1SNG626012R0000	50		
		15	0.591	0.866	0.866	25	32.2					EP-SGL-M16-LGR-E	1SNG626013R0000	EP-SGL-M16-GR-E	1SNG626014R0000	EP-SGL-M16-BL-E	1SNG626015R0000	50		
		8	0.315	19	19	21.7	27.4					EP-SGL-M16-LGR-F	1SNG626016R0000	EP-SGL-M16-GR-F	1SNG626017R0000	EP-SGL-M16-BL-F	1SNG626018R0000	50		
	4-8 0.157-0.315	10	0.394	0.748	0.748	0.854	1.079	0.591	0.748	0.854	1.079	EP-SGL-M16-LGR-G	1SNG626019R0000	EP-SGL-M16-GR-G	1SNG626020R0000	EP-SGL-M16-BL-G	1SNG626021R0000	50		
		15	0.591	0.748	0.748	21.7	27.4					EP-SGL-M16-LGR-H	1SNG626022R0000	EP-SGL-M16-GR-H	1SNG626023R0000	EP-SGL-M16-BL-H	1SNG626024R0000	50		
		10	0.394	22	22	25	32.2					EP-SGL-M16-LGR-I	1SNG626025R0000	EP-SGL-M16-GR-I	1SNG626026R0000	EP-SGL-M16-BL-I	1SNG626027R0000	50		
	5-10 0.197-0.394	15	0.591	0.866	0.866	0.984	1.268	0.591	0.866	0.984	1.268	EP-SGL-M16-LGR-J	1SNG626028R0000	EP-SGL-M16-GR-J	1SNG626029R0000	EP-SGL-M16-BL-J	1SNG626030R0000	50		
		10	0.394	24	24	27	32.4					EP-SGL-M20-LGR-A	1SNG626031R0000	EP-SGL-M20-GR-A	1SNG626032R0000	EP-SGL-M20-BL-A	1SNG626033R0000	50		
		15	0.591	0.945	0.945	1.063	1.276					EP-SGL-M20-LGR-B	1SNG626034R0000	EP-SGL-M20-GR-B	1SNG626035R0000	EP-SGL-M20-BL-B	1SNG626036R0000	50		
M20x1.5	5-9 0.197-0.354	10	0.394	24	24	27	32.4	0.591	0.945	1.063	1.276	EP-SGL-M20-LGR-C	1SNG626037R0000	EP-SGL-M20-GR-C	1SNG626038R0000	EP-SGL-M20-BL-C	1SNG626039R0000	50		
		15	0.591	0.945	0.945	1.063	1.276					EP-SGL-M20-LGR-D	1SNG626040R0000	EP-SGL-M20-GR-D	1SNG626041R0000	EP-SGL-M20-BL-D	1SNG626042R0000	50		
		10	0.394	27	27	30.9	31.9					EP-SGL-M20-LGR-E	1SNG626043R0000	EP-SGL-M20-GR-E	1SNG626044R0000	EP-SGL-M20-BL-E	1SNG626045R0000	50		
	6-12 0.236-0.472	15	0.591	1.063	1.063	1.217	1.256	0.591	1.063	1.217	1.256	EP-SGL-M20-LGR-F	1SNG626046R0000	EP-SGL-M20-GR-F	1SNG626047R0000	EP-SGL-M20-BL-F	1SNG626048R0000	50		
		10	0.394	25	25	27.5	34					EP-SGL-M20-LGR-G	1SNG626049R0000	EP-SGL-M20-GR-G	1SNG626050R0000	EP-SGL-M20-BL-G	1SNG626051R0000	50		
		10	0.394	27	27	30.9	31.9					EP-SGL-M20-LGR-H	1SNG626052R0000	EP-SGL-M20-GR-H	1SNG626053R0000	EP-SGL-M20-BL-H	1SNG626054R0000	50		
	7-13 0.276-0.512	15	0.591	1.063	1.063	1.217	1.256	0.591	1.063	1.217	1.256	EP-SGL-M20-LGR-I	1SNG626055R0000	EP-SGL-M20-GR-I	1SNG626056R0000	EP-SGL-M20-BL-I	1SNG626057R0000	50		
		10	0.394	29	29	32.5	37.7					EP-SGL-M25-LGR-A	1SNG626058R0000	EP-SGL-M25-GR-A	1SNG626059R0000	EP-SGL-M25-BL-A	1SNG626060R0000	25		
		15	0.591	1.142	1.142	1.280	1.484					EP-SGL-M25-LGR-B	1SNG626061R0000	EP-SGL-M25-GR-B	1SNG626062R0000	EP-SGL-M25-BL-B	1SNG626063R0000	25		
	M25x1.5	9-13 0.354-0.512	10	0.394	33	33	37.2	38.4	0.591	1.299	1.465	1.512	EP-SGL-M25-LGR-C	1SNG626064R0000	EP-SGL-M25-GR-C	1SNG626065R0000	EP-SGL-M25-BL-C	1SNG626066R0000	25	
			15	0.591	1.299	1.299	1.465	1.512					EP-SGL-M25-LGR-D	1SNG626067R0000	EP-SGL-M25-GR-D	1SNG626068R0000	EP-SGL-M25-BL-D	1SNG626069R0000	25	
			8	0.315	29	29	32.5	37.7					EP-SGL-M25-LGR-E	1SNG626070R0000	EP-SGL-M25-GR-E	1SNG626071R0000	EP-SGL-M25-BL-E	1SNG626072R0000	25	
11-17 0.433-0.669		15	0.591	1.142	1.142	1.280	1.484	0.591	1.142	1.280	1.484	EP-SGL-M25-LGR-F	1SNG626073R0000	EP-SGL-M25-GR-F	1SNG626074R0000	EP-SGL-M25-BL-F	1SNG626075R0000	25		
		10	0.394	33	33	37.2	38.4					EP-SGL-M25-LGR-G	1SNG626076R0000	EP-SGL-M25-GR-G	1SNG626077R0000	EP-SGL-M25-BL-G	1SNG626078R0000	25		
		15	0.591	1.299	1.299	1.465	1.512					EP-SGL-M25-LGR-H	1SNG626079R0000	EP-SGL-M25-GR-H	1SNG626080R0000	EP-SGL-M25-BL-H	1SNG626081R0000	25		
M32x1.5		11-15 0.433-0.591	10	0.394	36	36	41	42.3	0.591	1.417	1.614	1.665	EP-SGL-M32-LGR-A	1SNG626082R0000	EP-SGL-M32-GR-A	1SNG626083R0000	EP-SGL-M32-BL-A	1SNG626084R0000	20	
			15	0.591	1.417	1.417	1.614	1.665					EP-SGL-M32-LGR-B	1SNG626085R0000	EP-SGL-M32-GR-B	1SNG626086R0000	EP-SGL-M32-BL-B	1SNG626087R0000	20	
			12-20	0.591	42	42	47.1	43.3					EP-SGL-M32-LGR-C	1SNG626088R0000	EP-SGL-M32-GR-C	1SNG626089R0000	EP-SGL-M32-BL-C	1SNG626090R0000	20	
		12-20 0.472-0.787	15	0.591	1.654	1.654	1.854	1.705	0.591	1.654	1.854	1.705	EP-SGL-M32-LGR-D	1SNG626091R0000	EP-SGL-M32-GR-D	1SNG626092R0000	EP-SGL-M32-BL-D	1SNG626093R0000	20	
			10	0.394	36	36	41	42.3					EP-SGL-M32-LGR-E	1SNG626094R0000	EP-SGL-M32-GR-E	1SNG626095R0000	EP-SGL-M32-BL-E	1SNG626096R0000	20	
			15	0.591	1.417	1.417	1.614	1.665					EP-SGL-M32-LGR-F	1SNG626097R0000	EP-SGL-M32-GR-F	1SNG626098R0000	EP-SGL-M32-BL-F	1SNG626099R0000	20	
	18-25 0.708-0.984	15	0.591	42	42	47.1	43.3	0.591	1.654	1.854	1.705	EP-SGL-M32-LGR-G	1SNG626100R0000	EP-SGL-M32-GR-G	1SNG626101R0000	EP-SGL-M32-BL-G	1SNG626102R0000	10		
		18	0.709	1.811	1.811	2.063	1.866					EP-SGL-M40-LGR-A	1SNG626103R0000	EP-SGL-M40-GR-A	1SNG626104R0000	EP-SGL-M40-BL-A	1SNG626105R0000	15		
		10	0.394	46	46	52.4	47.4					EP-SGL-M40-LGR-B	1SNG626106R0000	EP-SGL-M40-GR-B	1SNG626107R0000	EP-SGL-M40-BL-B	1SNG626108R0000	10		
		18	0.709	1.811	1.811	2.063	1.866					EP-SGL-M40-LGR-C	1SNG626109R0000	EP-SGL-M40-GR-C	1SNG626110R0000	EP-SGL-M40-BL-C	1SNG626111R0000	15		
		20-26	0.787-1.024	18	0.709	53	53					59.6	52.4	EP-SGL-M40-LGR-D	1SNG626112R0000	EP-SGL-M40-GR-D	1SNG626113R0000	EP-SGL-M40-BL-D	1SNG626114R0000	10
		22-32	0.866-1.260	18	0.709	53	53					59.6	52.4	EP-SGL-M40-LGR-E	1SNG626115R0000	EP-SGL-M40-GR-E	1SNG626116R0000	EP-SGL-M40-BL-E	1SNG626117R0000	10

All the main technical data provided are "manufacturer" values  
Refers to UL files for precise approval per products



## X-ON Electronics

Largest Supplier of Electrical and Electronic Components

*Click to view similar products for [Cable Glands, Strain Reliefs & Cord Grips](#) category:*

*Click to view products by [TE Connectivity](#) manufacturer:*

Other Similar products are found below :

[1300980012](#) [DBZM-6828](#) [1498](#) [15190-103 R2](#) [1.587.3400.71](#) [300623](#) [07402002](#) [CD21NS-01](#) [VC-M-KV-PG16 1X3/1X8](#) [35935](#) [35882](#)  
[M4340GAE](#) [4597](#) [NG-9516 Gasket](#) [52006157](#) [52006176](#) [BM4963L](#) [53629556](#) [53629570](#) [53629675](#) [52025230](#) [52024853](#) [52103160](#)  
[52115810](#) [53017640](#) [53019051](#) [53019071](#) [53112270](#) [53112330](#) [53112840](#) [53112879](#) [53112929](#) [53111470](#) [53015270](#) [53015090](#) [53018090](#)  
[PG-29](#) [36681](#) [36550](#) [36310](#) [35880](#) [1300990004](#) [Z5.507.2321.0](#) [CGB295-SG](#) [5320816](#) [1.089.1399.19](#) [1.089.2106.19](#) [1.089.2905.19](#)  
[1.089.3699.19](#) [1.089.4801.19](#)