



**ELECTRONICS, INC.**  
 44 FARRAND STREET  
 BLOOMFIELD, NJ 07003  
 (973) 748-5089

## NTE2304 Silicon NPN Transistor High Current, High Speed Switch (Compl to NTE2314)

**Description:**

The NTE2304 is a silicon NPN transistor in a TO3P type package. Typical applications include relay drivers, high-speed inverters, converters, and other general high-current switching applications.

**Features:**

- Low Collector-Emitter Saturation Voltage
- Wide ASO and Resistant to Breakdowns

**Absolute Maximum Ratings:** ( $T_A = +25^\circ\text{C}$  unless otherwise specified)

Collector-Base Voltage, $V_{CBO}$ .....	60V
Collector-Emitter Voltage, $V_{CEO}$ .....	50V
Emitter-Base voltage, $V_{EBO}$ .....	6V
Collector Current, $I_C$	
Continuous .....	15A
Peak .....	20A
Allowable Collector Dissipation ( $T_C = +25^\circ\text{C}$ ), $P_C$ .....	90W
Operating Junction Temperature, $T_J$ .....	+150°C
Storage Ambient Temperature Range, $T_{stg}$ .....	-55° to +150°C

**Electrical Characteristics:** ( $T_A = +25^\circ\text{C}$  unless otherwise specified)

Parameter	Symbol	Test Conditions	Min	Typ	Max	Unit
Collector Cutoff Current	$I_{CBO}$	$V_{CB} = 40V, I_E = 0$	-	-	0.1	mA
Emitter Cutoff Current	$I_{EBO}$	$V_{EB} = 4V, I_C = 0$	-	-	0.1	mA
DC Current Gain	$h_{FE}$	$V_{CE} = 2V, I_C = 1A$	100	-	200	
		$V_{CE} = 2V, I_C = 8A$	30	-	-	
Current Gain-Bandwidth Product	$f_T$	$V_{CE} = 5V, I_C = 1A$	-	20	-	MHz
Collector-Emitter Saturation Voltage	$V_{CE(sat)}$	$I_C = 8A, I_B = 0.4A$	-	0.18	0.4	V
Collector-Base Breakdown Voltage	$V_{(BR)CBO}$	$I_C = 1mA, I_E = 0$	60	-	-	V
Collector-Emitter Breakdown Voltage	$V_{(BR)CBO}$	$I_C = 1mA, R_{BE} = \infty$	50	-	-	V
Emitter-Base Breakdown Voltage	$V_{(BR)EBO}$	$I_E = 1mA, I_C = 0$	6	-	-	V
Turn-On Time	$t_{on}$	$10I_{B1} = -10I_{B2} = I_C = 2A,$ $PW = 20\mu s$	-	0.2	-	$\mu s$
Storage Time	$t_{stg}$		-	1.0	-	$\mu s$
Fall Time	$t_f$		-	0.1	-	$\mu s$

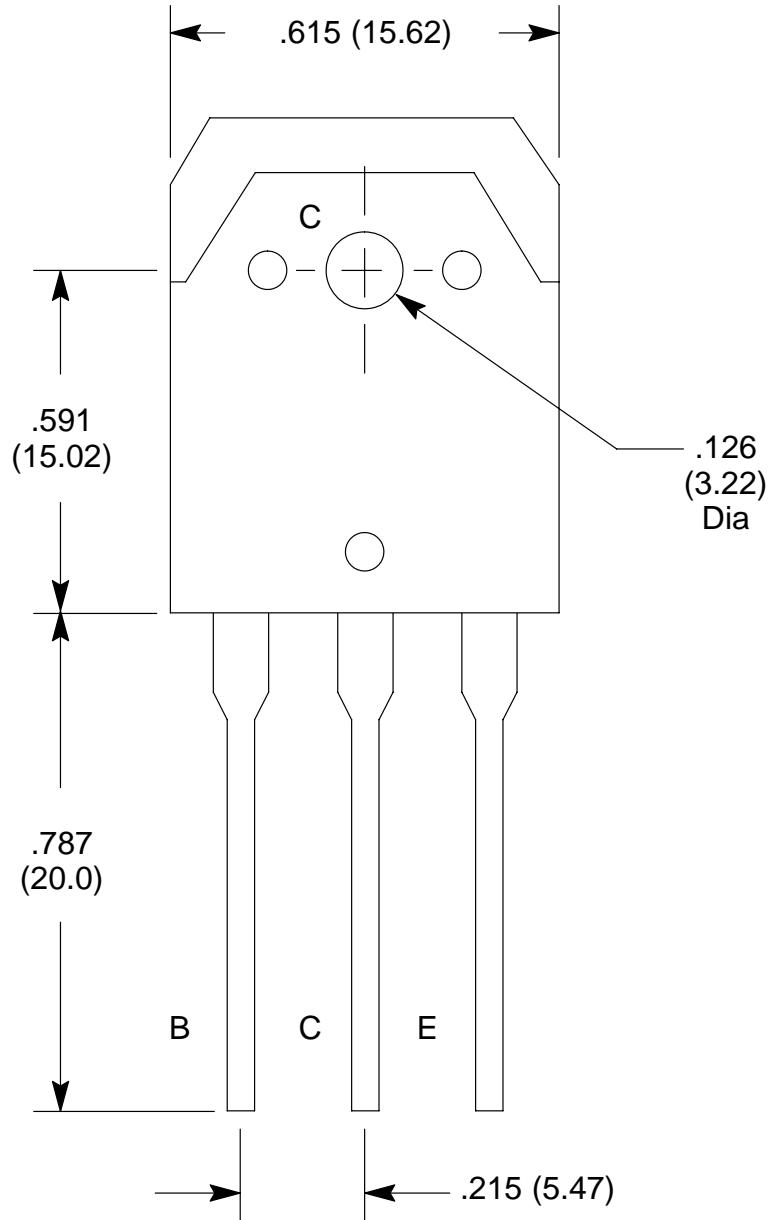
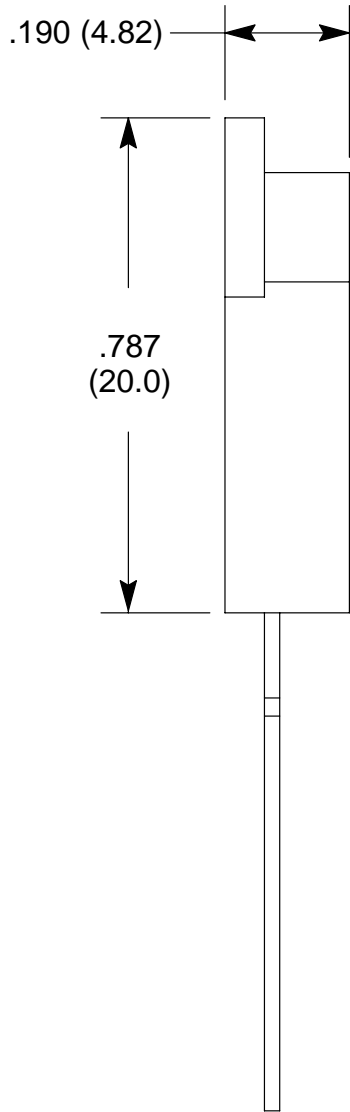

## X-ON Electronics

Largest Supplier of Electrical and Electronic Components

*Click to view similar products for [Bipolar Transistors - BJT category](#):*

*Click to view products by [NTE manufacturer](#):*

Other Similar products are found below :

[619691C](#) [MCH4017-TL-H](#) [MJ15024/WS](#) [MJ15025/WS](#) [BC546/116](#) [BC556/FSC](#) [BC557/116](#) [BSW67A](#) [HN7G01FU-A\(T5L,F,T](#)  
[NJVMJD148T4G](#) [NSVMMBT6520LT1G](#) [NTE187A](#) [NTE195A](#) [NTE2302](#) [NTE2330](#) [NTE2353](#) [NTE316](#) [IMX9T110](#) [NTE63](#) [NTE65](#)  
[C4460](#) [SBC846BLT3G](#) [2SA1419T-TD-H](#) [2SA1721-O\(TE85L,F\)](#) [2SA1727TLP](#) [2SA2126-E](#) [2SB1202T-TL-E](#) [2SB1204S-TL-E](#) [2SC5488A-](#)  
[TL-H](#) [2SD2150T100R](#) [SP000011176](#) [FMC5AT148](#) [2N2369ADCSM](#) [2SB1202S-TL-E](#) [2SC2412KT146S](#) [2SC4618TLN](#) [2SC5490A-TL-H](#)  
[2SD1816S-TL-E](#) [2SD1816T-TL-E](#) [CMXT2207 TR](#) [CPH6501-TL-E](#) [MCH4021-TL-E](#) [BC557B](#) [TTC012\(Q\)](#) [BULD128DT4](#) [JANTX2N3810](#)  
[Jantx2N5416](#) [US6T6TR](#) [KSF350](#) [068071B](#)