

Rubber buffers

Rubber and steel or stainless steel

STANDARD EXECUTIONS

- **DVA.3:** bushings with threaded blind holes and base plate in polished zinc-plated steel, vibration-damper body in natural rubber NR, black colour, hardness 40, 55, 70 Shore A ± 5 .
- **DVA.3-SST:** bushings with threaded blind holes and base plate in INOX AISI 304 stainless steel, vibration-damper body in natural rubber NR, black colour, hardness 55 Shore A ± 5 .

FEATURES AND APPLICATIONS

The rubber buffers have been designed to damp vibrations, shocks and noises produced by moving bodies or non-balanced vibrating masses of equipment and machines which can cause:

- malfunctioning and reduction of the machine lifespan and/or of the adjacent ones;
- damage to health;
- noise.

Load diagrams for each single code are available on request. See Technical data and guidelines for the choice.



SPECIAL EXECUTIONS ON REQUEST

Natural rubber NR, hardness 40, 70 tolerance ± 5 Shore A for executions with AISI 304 stainless steel base.

* Complete the description with the desired hardness: 40, 55 or 70 tolerance ± 5 Shore A.

DVA.3

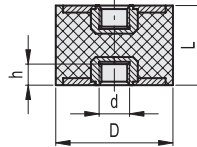

DVA.3 - 8 - 8 - M3 - 55
 D L d Shore A

DVA.3

Description	D	L	d	h	⚖️	Hardness 40 Shore A			Hardness 55 Shore A			Hardness 70 Shore A					
						Code	Max load [N]	Max deflection [mm]	Stiffness [N/mm]	Code	Max load [N]	Max deflection [mm]	Stiffness [N/mm]	Code	Max load [N]	Max deflection [mm]	Stiffness [N/mm]
DVA.3-8-8-M3-*	8	8	M3	3	1	414801	50	2	25	412301	85	2	43	417501	150	2	75
DVA.3-8-13-M3-*	8	13	M3	3	2	414805	41	3	13	412305	74	3	23	417505	152	3	47
DVA.3-10-10-M4-*	10	10	M4	4	2	414811	75	3	30	412321	100	3	40	417511	200	3	80
DVA.3-10-15-M4-*	10	15	M4	4	3	414821	65	4	17	412326	100	4	27	417521	150	4	40
DVA.3-10-20-M4-*	10	20	M4	4	3	414823	54	5	11	412329	108	5	22	417523	201	5	40
DVA.3-15-10-M4-*	15	10	M4	4	4	414831	210	2	105	412331	325	2	163	417531	717	2	359
DVA.3-15-15-M4-*	15	15	M4	4	6	414841	155	4	41	412341	280	4	75	417541	513	4	137
DVA.3-15-20-M4-*	15	20	M4	4	8	414851	151	5	30	412346	234	5	47	417551	468	5	94
DVA.3-16-15-M5-*	16	15	M5	5	10	414854	752	4	200	412348	2137	4	570	417555	2900	4	773
DVA.3-16-20-M5-*	16	20	M5	5	12	414855	290	5	58	412349	330	5	66	417557	655	5	131
DVA.3-20-15-M6-*	20	15	M6	6	13	414861	175	2	117	412351	227	2	151	417561	550	2	367
DVA.3-20-20-M6-*	20	20	M6	6	16	414871	220	5	44	412361	430	5	86	417571	995	5	199
DVA.3-20-25-M6-*	20	25	M6	6	19	414881	264	6	42	412371	433	6	69	417581	1010	6	162
DVA.3-25-20-M6-*	25	20	M6	6	26	414891	391	5	78	412381	620	5	124	417591	1533	5	307
DVA.3-25-25-M6-*	25	25	M6	6	29	414901	441	6	71	412386	529	6	85	417601	1374	6	220
DVA.3-25-30-M6-*	25	30	M6	6	25	414911	432	8	58	412391	524	8	70	417611	1208	8	161



Vibration mounts 21

* Complete the description with the desired hardness: 40, 55 or 70 tolerance ±5 Shore A.

DVA.3 - 8 - 8 - M3 - 55
 D L d Shore A

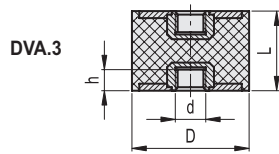

DVA.3

Description	D	L	d	h	⚖️	Hardness 40 Shore A			Hardness 55 Shore A			Hardness 70 Shore A					
						Code	Max load [N]	Max deflection [mm]	Stiffness [N/mm]	Code	Max load [N]	Max deflection [mm]	Stiffness [N/mm]	Code	Max load [N]	Max deflection [mm]	Stiffness [N/mm]
DVA.3-30-20-M8-*	30	20	M8	8	39	414921	770	1	1100	412401	1067	1	1524	417621	2260	1	3229
DVA.3-30-25-M8-*	30	25	M8	8	42	414926	4490	6	718	412411	8370	6	1339	417626	12630	6	2021
DVA.3-30-30-M8-*	30	30	M8	8	45	414931	500	8	67	412421	1055	8	141	417631	1960	8	261
DVA.3-30-40-M8-*	30	40	M8	8	53	414941	700	10	70	412431	2100	10	210	417641	2400	10	240
DVA.3-40-20-M8-*	40	20	M8	8	64	414950	815	3	255	412440	2650	5	530	417650	6200	2	2818
DVA.3-40-30-M8-*	40	30	M8	8	80	414951	1137	8	152	412441	1574	8	210	417651	3420	8	456
DVA.3-40-40-M8-*	40	40	M8	8	98	414961	1056	10	106	412461	1397	10	140	417661	3190	10	319
DVA.3-50-30-M10-*	50	30	M10	10	125	414971	2010	8	268	412463	3300	8	440	417671	5450	8	727
DVA.3-50-35-M10-*	50	35	M10	10	138	414976	2450	9	280	412464	2530	9	289	417676	5840	9	667
DVA.3-50-40-M10-*	50	40	M10	10	150	414981	1477	10	148	412466	2130	10	213	417681	4940	10	494
DVA.3-50-50-M10-*	50	50	M10	10	125	414991	1500	11	133	412469	2188	11	194	417691	4750	11	422
DVA.3-60-30-M10-*	60	30	M10	10	189	415001	3020	8	403	412471	4170	8	556	417701	9130	8	1217
DVA.3-60-40-M10-*	60	40	M10	10	220	415011	2520	10	252	412476	3610	10	361	417711	6950	10	695
DVA.3-60-50-M10-*	60	50	M10	10	310	415013	2930	13	234	412479	3410	13	273	417713	7125	13	570
DVA.3-70-30-M10-*	70	30	M10	10	305	415020	3168	4	792	412480	4900	4	1225	417720	7250	3	2417
DVA.3-70-35-M10-*	70	35	M10	10	315	415022	22540	9	2576	412482	8540	9	976	417693	15940	9	1822
DVA.3-70-45-M10-*	70	45	M10	10	335	415021	3810	11	339	412481	7130	11	624	417721	13210	11	1174
DVA.3-70-50-M10-*	70	50	M10	10	345	415023	3700	12	296	412491	5750	12	460	417694	14960	12	1197
DVA.3-75-30-M12-*	75	30	M12	12	320	415030	6880	3	2293	412500	9895	3	3192	417730	25000	5	5000
DVA.3-75-40-M12-*	75	40	M12	12	360	415031	4910	10	491	412501	6970	10	697	417731	11880	8	1485
DVA.3-75-50-M12-*	75	50	M12	12	375	415036	4120	12	330	412511	7110	12	569	417696	17900	12	1432
DVA.3-75-55-M12-*	75	55	M12	12	445	415041	3470	14	252	412521	7510	14	546	417741	11240	14	817
DVA.3-80-70-M14-*	80	70	M14	14	460	415046	4260	18	243	412531	7500	17	428	417698	13010	18	473
DVA.3-100-40-M16-*	100	40	M16	16	690	415051	13990	10	1399	412541	20000	10	2000	417751	29000	10	2900
DVA.3-100-55-M16-*	100	55	M16	16	765	415061	7320	14	532	412551	13080	14	951	417761	24260	14	1764
DVA.3-100-60-M16-*	100	60	M16	16	885	415071	7000	15	467	412561	11290	15	753	417771	28500	15	1900
DVA.3-100-75-M16-*	100	75	M16	16	965	415081	7790	19	415	412581	9640	19	514	417781	22350	19	1192
DVA.3-125-55-M16-*	125	55	M16	16	1320	415091	18240	14	1327	412591	19260	14	1401	417791	25000	8	3185
DVA.3-125-75-M16-*	125	75	M16	16	1500	415093	13380	19	714	412593	19440	19	1037	417793	23751	19	1267
DVA.3-150-55-M20-*	150	55	M20	20	1750	415095	9070	5	1814	412601	27900	9	3100	417801	23350	5	4670
DVA.3-150-75-M20-*	150	75	M20	20	1825	415097	18650	19	995	412611	27600	16	1725	417803	28600	10	2860
DVA.3-200-100-M20-*	200	100	M20	20	1900	415101	5490	5	1098	412631	28000	10	2667	417821	28400	7	4176

DVA.3-SST

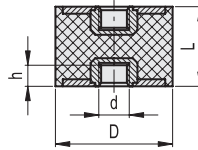

DVA.3 - 8 - 8 - SST - M3 - 55
 D L Stainless steel d Shore A

DVA.3-SST

STAINLESS STEEL

Description	D	L	d	h	Hardness 40 Shore A			Hardness 55 Shore A			Hardness 70 Shore A				
					Code	Max load [N]	Max deflection [mm]	Stiffness [N/mm]	Code	Max load [N]	Max deflection [mm]	Stiffness [N/mm]	Code	Max load [N]	Max deflection [mm]
DVA.3-8-8-SST-M3-55	8	8	M3	3	1	50	2	25	410201	85	2	43	150	2	75
DVA.3-8-13-SST-M3-55	8	13	M3	3	2	41	3	13	410203	74	3	23	152	3	47
DVA.3-10-10-SST-M4-55	10	10	M4	4	2	75	3	30	410205	100	3	40	200	3	80
DVA.3-10-15-SST-M4-55	10	15	M4	4	3	65	4	17	410207	100	4	27	150	4	40
DVA.3-10-20-SST-M4-55	10	20	M4	4	3	54	5	11	410209	108	5	22	201	5	40
DVA.3-15-10-SST-M4-55	15	10	M4	4	4	210	2	105	410213	325	2	163	717	2	359
DVA.3-15-15-SST-M4-55	15	15	M4	4	6	155	4	41	410215	280	4	75	513	4	137
DVA.3-15-20-SST-M4-55	15	20	M4	4	8	151	5	30	410217	234	5	47	468	5	94
DVA.3-16-15-SST-M5-55	16	15	M5	5	10	752	4	200	410219	2137	4	570	3200	4	853
DVA.3-16-20-SST-M5-55	16	20	M5	5	12	175	5	35	410220	330	5	66	655	5	131
DVA.3-20-15-SST-M6-55	20	15	M6	6	13	175	2	117	410221	227	2	151	550	2	367
DVA.3-20-20-SST-M6-55	20	20	M6	6	16	220	5	44	410223	430	5	86	995	5	199
DVA.3-20-25-SST-M6-55	20	25	M6	6	19	264	6	42	410225	433	6	69	1010	6	162
DVA.3-25-20-SST-M6-55	25	20	M6	6	26	391	5	78	410231	620	5	124	1533	5	307
DVA.3-25-25-SST-M6-55	25	25	M6	6	29	441	6	71	410233	529	6	85	1374	6	220
DVA.3-25-30-SST-M6-55	25	30	M6	6	25	432	8	58	410237	524	8	70	1208	8	161
DVA.3-30-20-SST-M8-55	30	20	M8	8	39	770	1	1100	410241	1067	1	1524	2260	1	3229
DVA.3-30-25-SST-M8-55	30	25	M8	8	42	4490	6	718	410242	8370	6	1339	12630	6	2021
DVA.3-30-30-SST-M8-55	30	30	M8	8	45	500	8	67	410243	1055	8	141	1960	8	261
DVA.3-30-40-SST-M8-55	30	40	M8	8	53	700	10	70	410245	2100	10	210	2400	10	240
DVA.3-40-20-SST-M8-55	40	20	M8	8	64	815	3	255	410251	2650	5	530	6200	2	2818
DVA.3-40-30-SST-M8-55	40	30	M8	8	80	1137	8	152	410253	1574	8	210	3420	8	456
DVA.3-40-40-SST-M8-55	40	40	M8	8	98	1056	10	106	410255	1397	10	140	3190	10	319
DVA.3-50-30-SST-M10-55	50	30	M10	10	125	2010	8	268	410263	3300	8	440	5450	8	727
DVA.3-50-35-SST-M10-55	50	35	M10	10	138	2450	9	280	410264	2530	9	289	5840	9	667
DVA.3-50-40-SST-M10-55	50	40	M10	10	150	1477	10	148	410265	2130	10	213	4940	10	494
DVA.3-50-50-SST-M10-55	50	50	M10	10	125	1500	11	133	410269	2188	11	194	4750	11	422
DVA.3-60-30-SST-M10-55	60	30	M10	10	189	3020	8	403	410271	4170	8	556	9130	8	1217
DVA.3-60-40-SST-M10-55	60	40	M10	10	220	2520	10	252	410273	3610	10	361	6950	10	695
DVA.3-60-50-SST-M10-55	60	50	M10	10	310	2930	13	234	410275	3410	13	273	7125	13	570
DVA.3-70-30-SST-M10-55	70	30	M10	10	305	3168	4	792	410276	4900	4	1225	7250	3	2417
DVA.3-70-35-SST-M10-55	70	35	M10	10	315	22540	9	2576	410278	8540	9	976	15940	9	1822
DVA.3-70-45-SST-M10-55	70	45	M10	10	335	3810	11	339	410277	7130	11	624	13210	11	1174
DVA.3-70-50-SST-M10-55	70	50	M10	10	345	3700	12	296	410279	5750	12	460	14960	12	1197
DVA.3-75-30-SST-M12-55	75	30	M12	12	320	6880	3	2293	410281	9895	3	3192	25000	5	5000
DVA.3-75-40-SST-M12-55	75	40	M12	12	360	4910	10	491	410283	6970	10	697	15380	10	1538
DVA.3-75-50-SST-M12-55	75	50	M12	12	375	4120	12	330	410284	7110	12	569	17900	12	1432
DVA.3-75-55-SST-M12-55	75	55	M12	12	445	3470	14	252	410285	7510	14	546	11240	14	817
DVA.3-80-70-SST-M14-55	80	70	M14	14	460	3390	17	199	410288	7500	17	429	10920	17	624
DVA.3-100-40-SST-M16-55	100	40	M16	16	690	13990	10	1399	410291	20000	10	2000	29000	10	2900
DVA.3-100-55-SST-M16-55	100	55	M16	16	765	7320	14	532	410293	13080	14	951	24260	14	1764
DVA.3-100-60-SST-M16-55	100	60	M16	16	885	7000	15	467	410295	11290	15	753	28500	15	1900
DVA.3-100-75-SST-M16-55	100	75	M16	16	965	7790	19	415	410297	9640	19	514	22350	19	1192
DVA.3-125-55-SST-M16-55	125	55	M16	16	1320	18240	14	1327	410298	19260	14	1401	25000	8	3185
DVA.3-125-75-SST-M16-55	125	75	M16	16	1500	13380	19	714	410299	19440	19	1037	23751	19	1267
DVA.3-150-55-SST-M20-55	150	55	M20	20	1750	9070	5	1814	410300	27900	9	3100	23350	5	4670
DVA.3-150-75-SST-M20-55	150	75	M20	20	1825	18650	19	995	410302	27600	16	1725	28600	10	2860
DVA.3-200-100-SST-M20-55	200	100	M20	20	1900	5490	5	1098	410304	28000	10	2667	28400	7	4176

Vibration mounts 21

X-ON Electronics

Largest Supplier of Electrical and Electronic Components

Click to view similar products for [Elesa & Ganter](#) manufacturer:

Other Similar products are found below :

[11352-R](#) [11353](#) [11354-R](#) [13651](#) [13671](#) [13681](#) [13691](#) [13721](#) [13726](#) [13741](#) [13751](#) [13771](#) [137901](#) [141131](#) [141141](#) [141221](#) [141311](#) [141331](#)
[141335](#) [141341](#) [141421](#) [141441](#) [141471](#) [141511](#) [141531](#) [141541](#) [141561](#) [142121](#) [142211](#) [142231](#) [142351](#) [220416-C1](#) [221206-C1](#) [221206-](#)
[C2](#) [221206-C3](#) [221206-C4](#) [221206-C5](#) [221206-C6](#) [221221-C1](#) [221221-C2](#) [221221-C3](#) [221221-C4](#) [221221-C5](#) [221221-C6](#) [221226-C1](#)
[221406-C1](#) [221406-C3](#) [221426-C1](#) [221431-C2](#) [221436-C6](#)