

技术特性/Specifications:

额定电压 Rated voltage: 12V AC, DC
额定电流 Rated current: 3mA AC, DC
接触电阻 Contact resistance: 20m Ω max
绝缘电阻 Insulation resistance: 100M Ω min
耐压 Withstand voltage: 1000V AC/minute
环境温度 Ambient temperature: -40 $^{\circ}$ C~+105 $^{\circ}$ C
适用线规 Wire range: AWG#24~#20

REV.	REVISION DESCRIPTION	DATE	APPD

NOTES

Available in 08 through 40 Circuits.

Match with DL22001-Y series housing.

Material : PBT UL94-V0.

Pin Material : Brass .

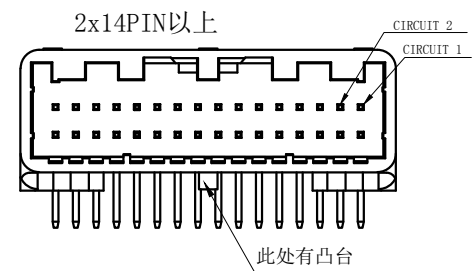
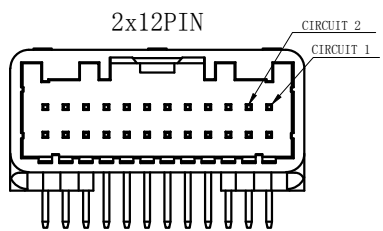
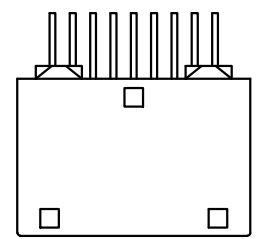
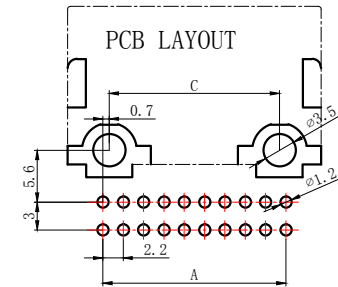
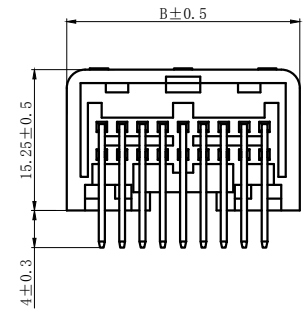
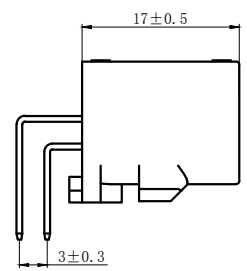
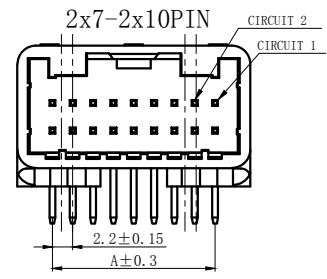
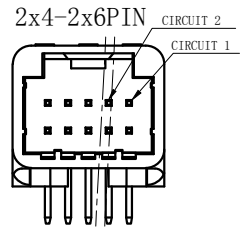
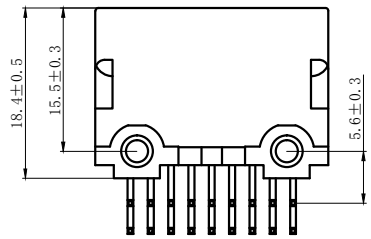

Circuits	Product name	Dimensino (mm)			Circuits	Product name	Dimensino (mm)		
		A	B	C			A	B	C
2X4	QA-8AW	6.60	14.20	8.20	2X10	QA-20AW	19.80	27.40	21.50
2X5	QA-10AW	8.80	16.40	9.50	2X12	QA-24AW	24.20	31.80	23.10
2X6	QA-12AW	11.00	18.60	9.60	2X14	QA-28AW	28.60	36.20	27.20
2X7	QA-14AW	13.20	20.80	11.80	2X16	QA-32AW	33.00	40.60	31.60
2X8	QA-16AW	15.40	23.00	14.00	2X20	QA-40AW	41.80	49.40	40.40
2X9	QA-18AW	17.60	25.20	16.20					

GENERAL TOLERANCES (UNLESS SPECIFIED)		ZHE JIANG DELI CONNECTORS CO., LTD	
.X: ± 0.25	X°: ± 3.0°	PRODUCT NAME: DL22001 (QA)-AW	TITLE: 2.20 mm Pitch Housing
.XX: ± 0.15	.X°: ± 2.0°	DR: Chen Quan Long	DATE: 22/08/01
.XXX: ± 0.01	.XX°: ± 1.0°	CHKD: Wu Hui	DATE: 22/08/01
FINISH:		APPD: Ren An De	DATE: 22/08/01
DRAWING NO:			
		SCALE: N/A	PAGE: 1/1
		UNITS: mm	REV.: A

REV.	REVISION DESCRIPTION	DATE	APPD

NOTES

Available in 08 through 40 Circuits.
 Match with DL22001 series housing.
 Material : PBT UL94-V0.
 Accepts DL22001-T Crimp Terminal.

2	②	护圈	PBT	1
1	①	底座	PBT	1
序号	图号	名称	材料	数量

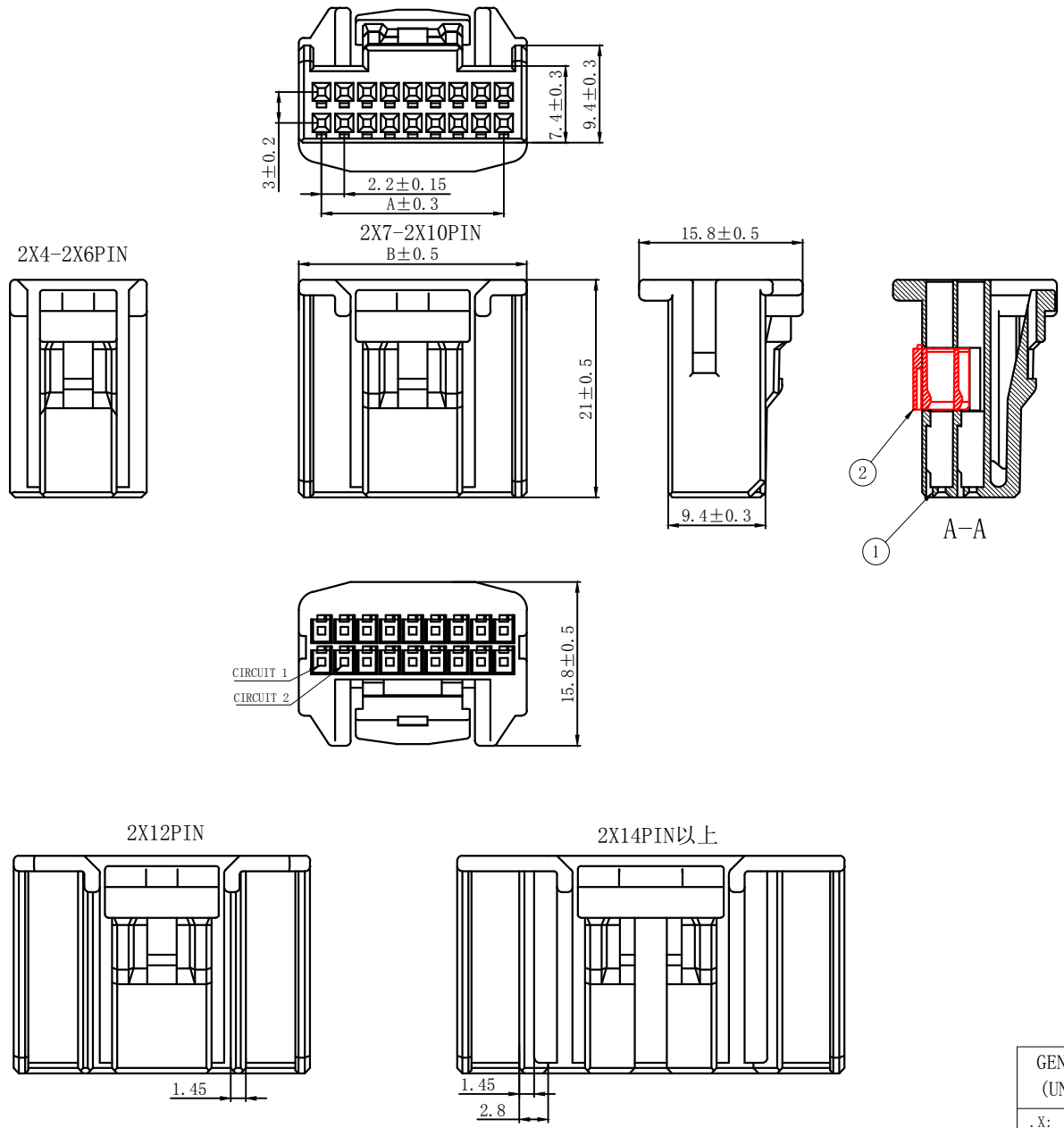

Circuits	product name	Dimensino (mm)		Circuits	product name	Dimensino (mm)	
		A	B			A	B
2X4	QA-8Y	6.60	11.00	2X10	QA-20Y	19.80	24.20
2X5	QA-10Y	8.80	13.20	2X12	QA-24Y	24.20	28.60
2X6	QA-12Y	11.00	15.40	2X14	QA-28Y	28.60	33.00
2X7	QA-14Y	13.20	17.60	2X16	QA-32Y	33.00	37.40
2X8	QA-16Y	15.40	19.80	2X20	QA-40Y	41.80	46.20
2X9	QA-18Y	17.60	22.00				

GENERAL TOLERANCES (UNLESS SPECIFIED)		ZHE JIANG DELI CONNECTORS CO., LTD	
.X: ± 0.25	X°: ± 3.0°	PRODUCT NAME: DL22001 (QA)-Y	TITLE: 2.00 mm Pitch Housing
.XX: ± 0.15	.X°: ± 2.0°	DR: Chen Quan Long	DATE: 23/09/01
.XXX: ± 0.01	.XX°: ± 1.0°	CHKD: Wu Hui	DATE: 23/09/01
FINISH:		APPD: Ren An De	DATE: 23/09/01
DRAWING NO:			SCALE: N/A
			PAGE: 1/1
			UNITS: mm
			REV.: A

REV.	REVISION DESCRIPTION	DATE	APPD

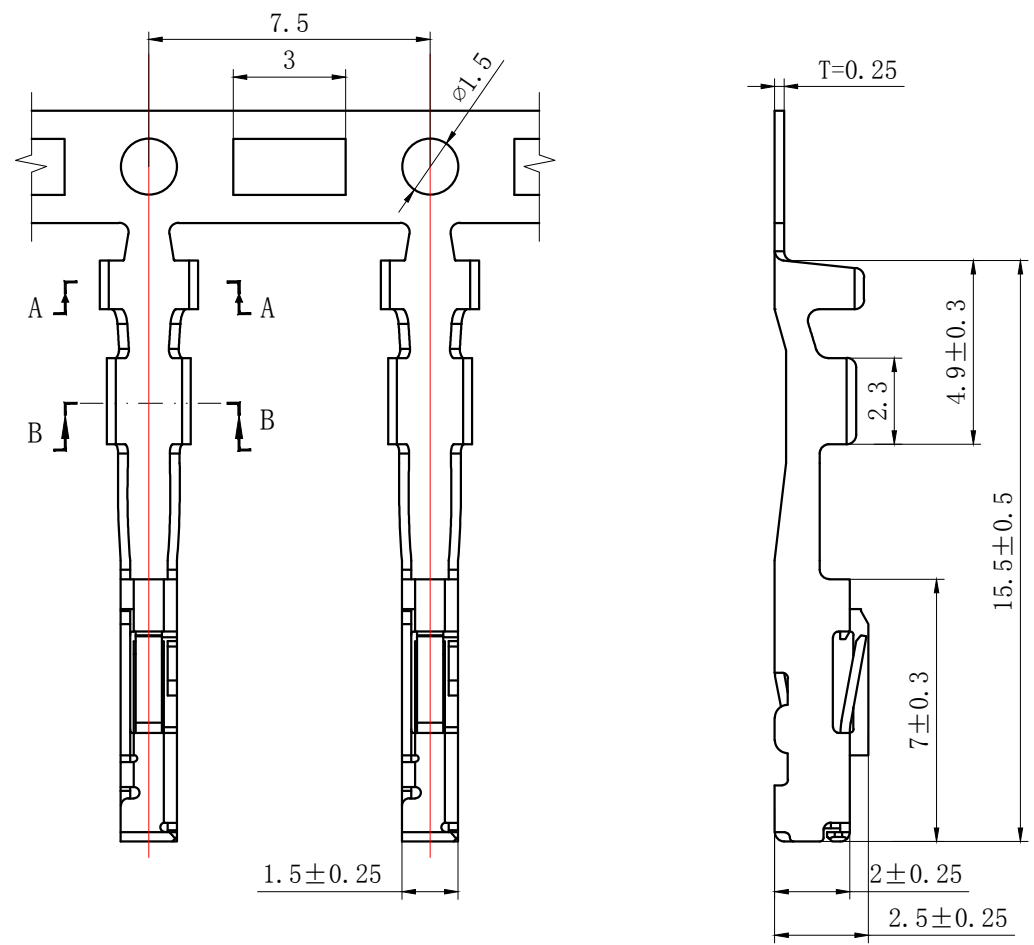

1.5 ± 0.25

$T=0.25$

2 ± 0.25
 2.5 ± 0.25
 7 ± 0.3
 4.9 ± 0.3
 15.5 ± 0.5

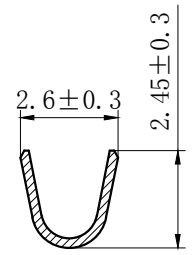

SECTION A-A

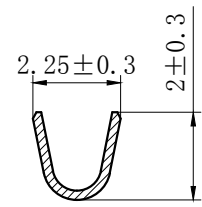

SECTION B-B

NOTES

Used in DL22001-Y Series Housing.
 Accepts AWG #20~24 Wire Range.
 Material : Phosphor Bronze .
 Finish: Tin plated.
 Thickness: 0.25 mm.

GENERAL TOLERANCES (UNLESS SPECIFIED)		ZHE JIANG DELI CONNECTORS CO., LTD	
.X: ± 0.25	X°: $\pm 3.0^\circ$	PRODUCT NAME: DL22001 (QA)-T	TITLE: 2.20 mm Pitch Crimp Terminal
.XX: ± 0.15	.X°: $\pm 2.0^\circ$	DR: Chen Quan Long	DATE: 22/08/01
.XXX: ± 0.01	.XX°: $\pm 1.0^\circ$	CHKD: Wu Hui	DATE: 22/08/01
DRAWING NO:		APPD: Ren An De	DATE: 22/08/01
		SCALE: N/A	PAGE: 1/1
		UNITS: mm	REV.: A

X-ON Electronics

Largest Supplier of Electrical and Electronic Components

Click to view similar products for [Automotive Connectors](#) category:

Click to view products by [DLL](#) manufacturer:

Other Similar products are found below :

[60993906-B](#) [72.330.1035.1](#) [776880-1](#) [827153-1](#) [9-1326729-8](#) [9-221607-5](#) [925474-1](#) [964562-4](#) [968782-1](#) [12004468](#) [12004475-L](#) [12004483](#)
[12033816](#) [12052466](#) [12066163](#) [12015909](#) [12047958](#) [12084688](#) [12336-12](#) [13579678](#) [13669373](#) [13681974](#) [13688972](#) [13779834](#) [13796274](#)
[13843152](#) [13581967](#) [13667961](#) [13669624](#) [13675513](#) [13753471](#) [13946876](#) [13955963](#) [13971791](#) [13979933](#) [13790534-L](#) [13797473](#)
[13888202](#) [1428188-1](#) [1437287-3](#) [1428188-2](#) [DS07-19S-5020](#) [1456987-7](#) [APD-7CP-H](#) [APK-SB25A10L](#) [1452931-2](#) [15317331](#) [15326397](#)
[15336198](#) [15435215](#)