

THIS DOCUMENT IS SUBJECT TO CHANGE WITHOUT NOTICE. IT IS CONFIDENTIAL AND A PROPERTY OF Amphenol LTW. DISCLOSURE TO THIRD PARTY HAS TO BE AUTHORIZED BY Amphenol LTW.

REV.	ECN NO.	DATE	SIGN	DESCRIPTION
B	C201781	2020/11/12	Ruru	\triangle_B X3
C	C210497	2021/03/30	Ruru	\triangle_C X2
D	C230014	2022/12/30	Ruru	\triangle_D X2

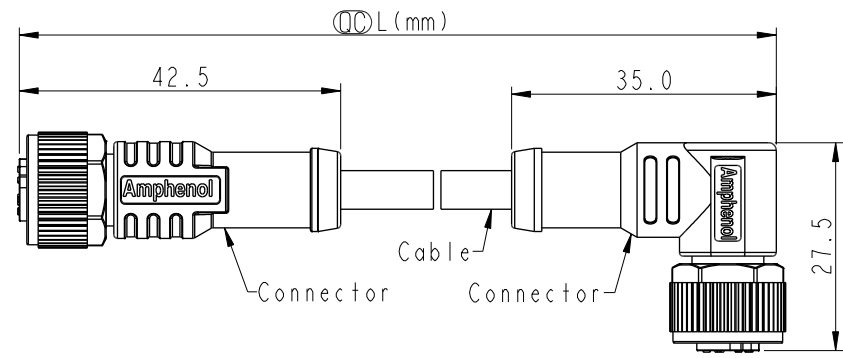
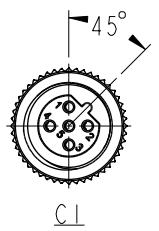

\triangle_B
MSBPXXFL-SBPFR-SBXXX

XX: No. Of Pin

XXX: 0.5-99Meters
 A05: 0.5 Meter
 1: 01 Meter
 2: 02 Meters
 ...
 99: 99 Meters

Pin Out	Wire Color	Wire Color (Chinese)
5	Gray	灰
4	Black	黑
3	Blue	藍
2	White	白
1	Brown	棕

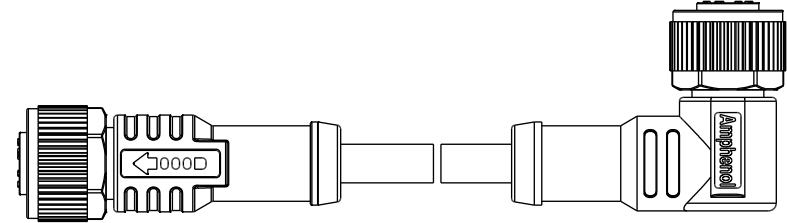
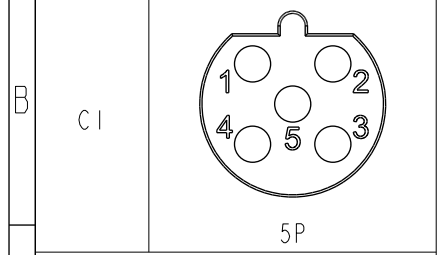
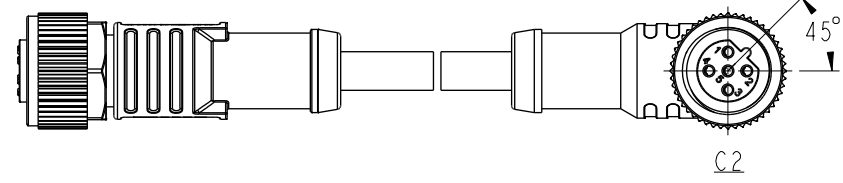
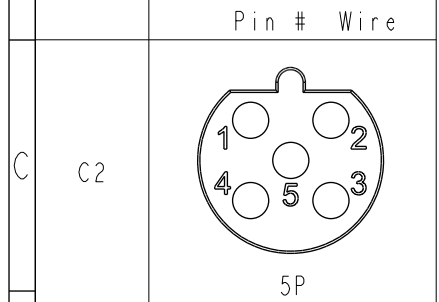

Note: \triangle_B \triangle_C

- * RoHS Compliant
- * \odot Important dimension
- * C1
- \triangle_D Waterproof rate: IP68, mated 1m/24h
 IP69K, mated
 Housing: Thermoplastic, Black
 Pin: Copper alloy, Gold plated
 O-Ring: Rubber, Green
 Nut: Thermoplastic, Black
 Outer mold: Thermoplastic, Black
- * C2
- \triangle_D Waterproof rate: IP68, mated 1m/24h
 IP69K, mated
 Housing: Thermoplastic, Black
 Pin: Copper alloy, Gold plated
 O-Ring: Rubber, Green
 Nut: Thermoplastic, Black
 Outer mold: Thermoplastic, Black
- * Cable: UL20549, 22#5C, OD=4.4mm, PUR Jacket, Black
- * Cable length tolerance: 0.5M < L ≤ 1M: +60/-0 mm
 1M < L ≤ 3M: +120/-0 mm
 3M < L ≤ 5M: +160/-0 mm
 5M < L ≤ 10M: ±100 mm
 10M < L ≤ 20M: ±200 mm
 20M < L ≤ 30M: ±300 mm
 30M < L ≤ 99M: ±500 mm

Pin Assignments Front View

UNIT:mm TOLERANCE ± 0.5 mm	TITLE ACC, SEN, B Code, DB-ENDED FF		Amphenol LTW 安費諾亮泰企業股份有限公司	ITEM NO	DRAWN BY Ruru	DATE 2018-12-10		
	SCALE 1:2	SIZE A4		SHEET 1	OF 1	DWG NO \triangle_B MSBPXXFL-SBPFR-SBXXX	CHECKED BY Rita	DATE 2018-12-10
	REV. D	WC-REV.		\odot : Inspection item		CUSTOMER ALTW	APPROVED BY Max	DATE 2018-12-10

X-ON Electronics

Largest Supplier of Electrical and Electronic Components

Click to view similar products for [Sensor Cables / Actuator Cables](#) category:

Click to view products by [Amphenol](#) manufacturer:

Other Similar products are found below :

[60963](#) [M83513/19-F01CP](#) [703000D02F2002](#) [703000D02F300](#) [703001D02F1201](#) [704000D02F120](#) [802027213811-1](#) [84914-0235](#)
[883030A09M050](#) [884031A09M005](#) [8R4006A18M010](#) [1200980008](#) [1200980031](#) [1211810021](#) [1400637](#) [1401201](#) [1401348](#) [1405278](#)
[1408644/94F/8](#) [1455311](#) [1513981](#) [1550119](#) [1554212](#) [1R3006A20A120G](#) [1R4004A17A120](#) [1R4006A20A1202](#) [1R4006A39M005](#) [2289297-6](#)
[8R3006A16A1203](#) [8R5E36E03M020](#) [2R7004A20F060](#) [301000A01F200](#) [301002A01F120](#) [2289297-1](#) [2289297-8](#) [2289297-9](#)
[302000A01F120](#) [CONM6A-S2](#) [309000A01F0301](#) [332021A01F200](#) [3R1006A20F030](#) [3R9006A20A1201](#) [403001A10M040](#)
[4030P1A10M040](#) [41-01023](#) [MBCC-412](#) [331020A01F060](#) [1R3G06A20A120](#) [543031A10M010](#) [884030K05M060](#)