



Amphe-OBTS

Amphenol Industrial Products Group introduces a new power connector family, the Amphe-OBTS. This innovative connector series is designed for the next generation of base stations.

Amphe-OBTS is a circular connector based on the MIL-C-26482 series 2 with clip retention contacts. Features zinc shell construction, provides EMI shielding, is shock & vibration resistant, and uses screw termination contacts making it well suited for field installation.

We offer the Amphe-OBTS in our standard 2-way 60V DC power configuration but also manufacture a 60V DC 2-way reverse gender and a 3-way 400VDC/250V AC connector. Standard current for the two pole version is 26A per contact while the three pole version supplies 16A per contact.

Contact Amphenol Industrial Products Group for more product details.

Features:

- UL1977 certified
- IEC 61984 and 60950-22 certified
- Zinc shell construction with tin/nickel plating
- Bayonet locking
- 26A per contact (two pole); 16A per contact (three pole)
- 360° EMI shielding
- Working temperature of -55°C to +105°C
- IP67 rated
- Receptacle with crimp contacts
- Plug with screw termination contacts for field installation
- Cable sealing range is 6-18mm OD
- UL94-V0
- ISO 21207 Method B 5 cycles for corrosion test



Specifications

Electrical Rating	2 way 26A / 60V DC	UL1977
	3 way 16A / 250V AC	UL1977
	3 way 16A / 250V AC	IEC 61984 ,60950-22
	3 way 10A / 400V DC	UL1977
	3 way 10A / 400V DC	IEC 61984 ,60950-22
Temperature Rating	-55°C to +105°C	
Contact Termination	Unit Mounted Receptacle	1mm ² – 2.5mm ²
	Field-Installable Plug	2.5mm ² – 10mm ²
Overvoltage Protection (10/350 μs Lightning Strike)	20kA	
Environmental	Water Ingress	IP67 (when mated)
Mating Sequence	FMLB (First mate / Last Break)	Shell on 2-Way DC / Ground pin on 3-Way AC
PIM (Passive Inter-Modulation)	PIM < -140dBc @ 38dBm	

All measurements are in mm.

C10-730511-Z2P
2 WAY 48 V DC MALE PANEL RECEPTACLE
IEC61984 & IEC60950-22 Certified

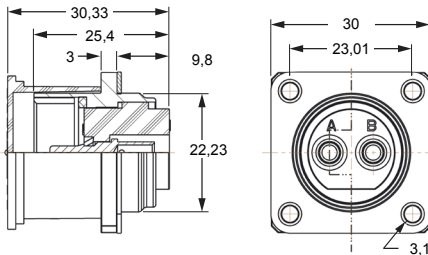

C10-730511-Z2S
2 WAY 48 V DC FEMALE STRAIGHT PLUG
IEC61984 & IEC60950-22 Certified

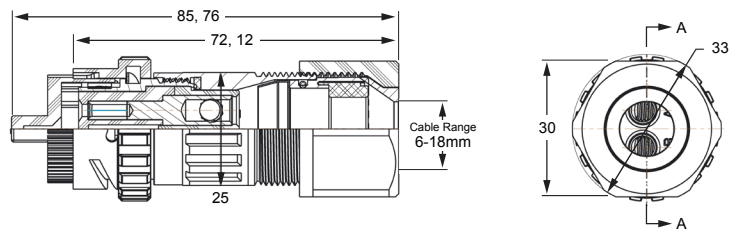

C10-730512-Z2S
2 WAY 48 VDC FEMALE PANEL RECEPTACLE
IEC61984 & IEC60950-22 Certified

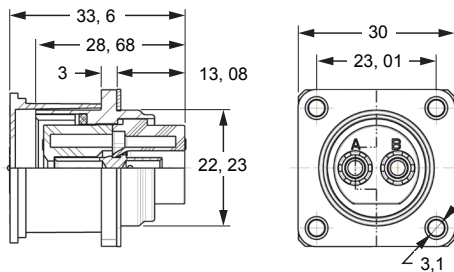

C10-730512-Z2P
2 WAY 48 VDC MALE STRAIGHT PLUG
IEC61984 & IEC60950-22 Certified

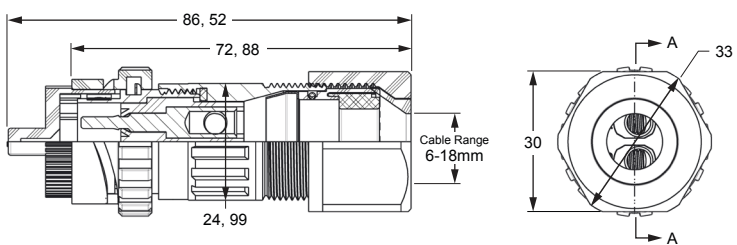

C10-730513-Z3P
3 WAY 400VDC/250V AC MALE PANEL RECEPTACLE
IEC61984 & IEC60950-22 Certified

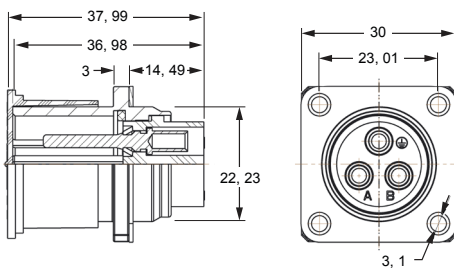

C10-730513-Z3S
3 WAY 400VDC/250V AC STRAIGHT PLUG
IEC61984 & IEC60950-22 Certified

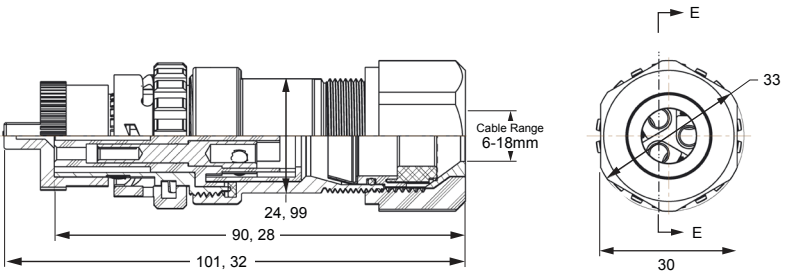

For further information on your individual application requirements, contact: Amphenol Corporation

North America:
Amphenol Industrial Operations
180 N. Freeport Drive, Plant 4
Nogales, AZ 85621
Tel: (888) 364-9011
Fax: (520) 285-5134

Email: tech@amphenol-aio.com

Europe:
Amphenol Industrial Operations Europe
Via Barbaiana 5
1-20020 Lainate (MI) Italy
Tel: +39 02 93254.204
Fax: +39 02 93254.444

Email: info@amphenol-aio.com

Middle East:
Amphenol Middle East Enterprises FZE
Office C-37 PO Box 21107
Ajman Free Zone, UAE
Tel: +9 716-7422494
Fax: +9 716-7422941

Email: jhussain@amphenol-industrial.com

Asia:
Amphenol Technology (Zhuhai) Co., Ltd.
No. 63 Xin Han Road, San Zao Town
Jin Wan District, Zhuhai City, China 519040
Tel: +86 756-3989760
Fax: +86 756-3989768

Email: enquiry@amphenol-aio.com

X-ON Electronics

Largest Supplier of Electrical and Electronic Components

Click to view similar products for [Circular MIL Spec Connector](#) category:

Click to view products by [Amphenol](#) manufacturer:

Other Similar products are found below :

[0025-262-542](#) [0025-264-3014](#) [58-570121-04S](#) [0134-202-1200](#) [0134-207-1206](#) [0134-207-1800](#) [0134-207-2207](#) [0134-213-0806](#) [0134-213-1007](#) [0134-213-1009](#) [0134-213-1208](#) [0134-213-1800](#) [0134-213-2209](#) [0025-258-000](#) [015-9516-002](#) [60-042722-19P](#) [0114-201-1278](#) [602GB06EG24-61SN](#) [0134-201-1207](#) [0134-201-1806](#) [0134-201-2006](#) [0134-201-2007](#) [0134-201-2010](#) [0134-202-1400](#) [0134-207-0809](#) [0134-207-1208](#) [0134-207-2009](#) [0134-213-1006](#) [6104-207-2302](#) [6104-208-1902](#) [6131-202-19149P](#) [6131-204-21149P](#) [6131-207-13149P](#) [6131-208-13149P](#) [6131-209-17149P](#) [6131-210-11149P](#) [6131-211-19149P](#) [6131-216-19149P](#) [6131-220-25149P](#) [6131-259-11149P](#) [6131-259-21149P](#) [6131-259-23149P](#) [6131-263-19149P](#) [6131-265-17149P](#) [6131-265-19149P](#) [CS3102A-20-15P](#) [CS3102A-20-15S](#) [CS3102C18-4P-472](#) [CS3106A-20-29P](#) [CS3106A-20-74P](#)