



**Solder**

**Crimp**

- General purpose
- Closed-entry socket contacts
- Solder termination

KPT connectors are a series of general - purpose, environment - resistant, miniature circular connectors, qualified for use in industrial applications calling for quick - disconnect connectors with fixed contacts for solder termination. These miniature circular connectors are grouped into two series ranging from general purpose solder pot connectors . . . to high performance, crimp connectors . . . to connectors with high contact density. This broad range provides the most complete family of 26482 connectors available today. The versatility of these connectors is proven by the fulfillment of requirements ranging from general purpose to space environmental.

In addition to the two basic series, connectors for special applications are also available. They include RFI filtering versions (with loss pass internal filter pin contacts), hermetic connectors for high pressure watertight requirements, and twist - on pull - off couplers for MIL-C-26482 plugs. This series is intermateable and intermountable with all MIL-C-26482 connectors, whether solder or crimp type and is available with many materials, finishers and configurations.

## How to Order - KPT - Solder Contact Connectors

### SERIES PREFIX

- KPT - ITT Cannon prefix
- MS - MIL-C-26482 prefix

### SHELL STYLE

- Cannon Designation
- 00 - wall mounting receptacle
- 01 - cable connecting plug
- 02 - box mounting receptacle (Class E only)
- \* 03 - wall mounting receptacle without grommet, ferrule and endbell
- \* 04 - cable connecting plug without grommet, ferrule and endbell
- \* 05 - straight plug without grommet, ferrule, and endbell
- 06 - straight plug
- 07 - jam nut receptacle (available in hermetic version also)
- 08 - 90° angle plug
- B - thru-bulkhead receptacle (Class E only)

\* Consult factory for details

### SHELL STYLE (cont'd)

- MS Designation
- 3110 - wall mounting receptacle
- 3111 - cable connecting plug
- 3112 - box mounting receptacle (Class E only)
- 3114 - jam nut receptacle
- 3116 - straight plug
- 3119 - thru-bulkhead receptacle (Class E only)

SERIES PREFIX

SHELL STYLE

CLASS

SHELL SIZE

CONTACT ARRANGEMENT

CONTACT STYLE

ALTERNATE INSERT POSITION

MODIFICATION CODE

### CLASS

- A - general duty (not MS approved)
- B - general duty with strain relief without grommet & ferrules (may be used for potting when strain relief is desired) (not MS approved)
- E - grommet seal except on 02 and 3112 (MS specification)
- F - grommet seal with strain relief (MS specification)
- J - water tight gland seal with strain relief for jacketed cable (MS specification)
- P - potted (MS specification)

### SHELL SIZE

- 8, 10, 12, 14, 16, 18, 20, 22, and 24

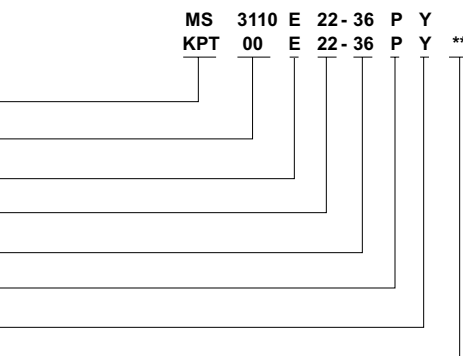

### CONTACT ARRANGEMENT

See contact arrangement page 149.

### CONTACT STYLE

P - pin; S - socket

### ALTERNATE INSERT POSITION

W, X, Y and Z. (Omit for normal.)

### MODIFICATION CODE

- Omit first (0) of shell style indication when using modifications code.
- 07 - clear chromate over cadmium
- 16 - twist-pull lanyard release coupler (applied cable to plug only).
- 23 - grounding springs fingers (applicable to plug only)

## How to Order - KPTB Thru-Bulkhead Receptacle Connectors

- General Purpose
- Double ended pin and socket contacts
- Contains KPT socket insert
- Nonremovable contacts

KPT connectors are a series of general - purpose, miniature circular connectors, qualified for use in military applications. They are also widely used in industrial applications. The KPTB in a thru-bulkhead version with double faced pin and socket insert construction allowing mating from both ends. They contain KPT socket inserts with feed-thru (pin/socket) non-removable contacts.

The thru-bulkhead receptacle is provided for applications requiring the disconnection of a power source from either side of a panel. A typical connector to be used if air leakage requirements are critical.

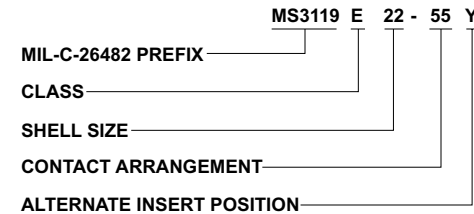
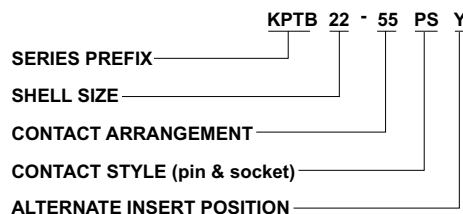

## How to Order - KPSE Crimp Contact Connectors

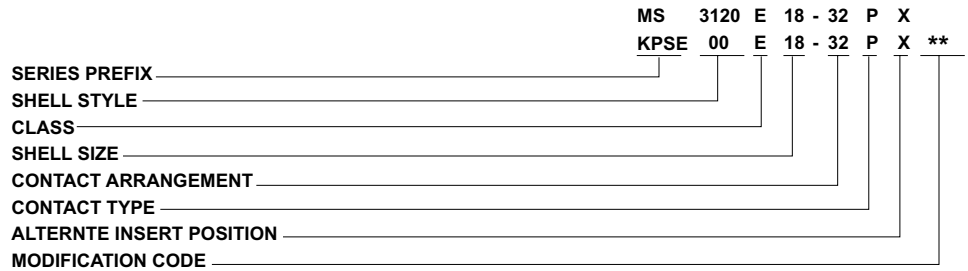

### SERIES PREFIX

KPSE - ITT Cannon prefix  
MS - MIL-C-26482 prefix

### SHELL STYLE

ITT Cannon Number:  
00 - wall mounting receptacle  
01 - cable connecting plug  
02 - box mounting receptacle (without wire seals)  
\* 03 - wall mounting receptacle without ferrule and endbell  
\* 04 - cable connector plug without ferrule and endbell  
\* 05 - straight plug without ferrule and endbell  
06 - straight plug  
07 - jam nut receptacle  
08 - 90° angle plug

\* Consult factory for details

### MS Designation

3120 - wall mounting receptacle  
3121 - cable connecting plug  
3122 - box mounting receptacle  
3124 - jam nut receptacle  
3126 - straight plug

### CLASS

A - general duty (not MS approved)  
B - general duty with strain relief without grommet & ferrules (not MS approved)  
E - grommet seal (MS specification)  
F - grommet seal with strain relief (MS specification)  
J - gland seal with strain relief for jacketed cable (not MS approved)  
P - potted (MS specification)

### SHELL SIZE

10, 12, 14, 16, 18, 20, 22, and 24

### CONTACT ARRANGEMENT

See contact arrangements page 149.

### CONTACT STYLE

P - pin  
S - socket

### ALTERNATE INSERT POSITION

W, X, Y and Z. (Omit for normal.)

### MODIFICATION CODE

Omit first (0) of shell style indication when using modifications code.  
F0 - less contacts, not marked on connectors  
07 - clear chromate over cadmium  
16 - twist-pull lanyard release coupler (applied cable to plug only).  
23 - grounding springs fingers (applicable to plug only)

## KPSE High Performance Crimp Contact Connectors

- Environment -resistant
- Voidless integrally molded insulator
- Front-release, crimp snap-in contacts
- Closed entry socket contacts
- 4 moisture seals for complete sealing
- Contact clip protected in hard dielectric
- Positive insert-to-shell mechanical retention

KPSE environment-resistant, miniature circular, quick disconnect connectors, qualified to MIL-C-26482, are designed for the exacting requirements of today's electronic industry. The KPSE features an insulator which is mechanically retained in the shell by a positive, hard plastic-to-metal lock retention augmented by a reliable adhesive bond. Complete moisture sealing is achieved by four seal; shell, peripheral, interfacial and wire seals.

Crimp snap-in contacts are retained in clips that are completely encased in a tough hard dielectric wafer, thus protecting the clips tines from damage. Closed-entry socket contacts facilitate positive mating.

The KPSE series is intermateable, intermountable and interchangeable with all MIL-C-26482 connectors, whether crimp or solder type, and is available with many materials, finishes and configurations.

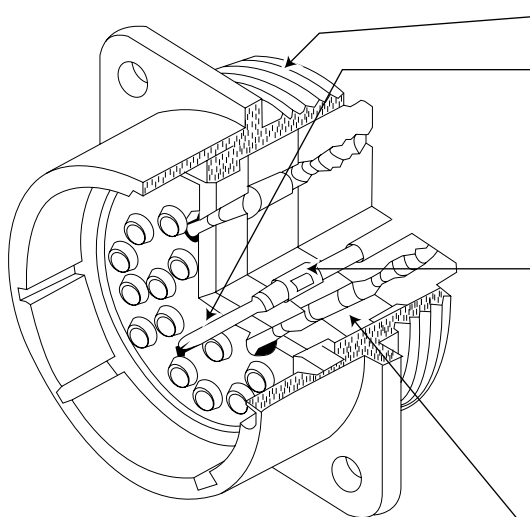

**STANDARD MIL-C-26482 HARDWARE** mates with any connector designed to MIL-C-26482.

**CRIMP, SNAP-IN CONTACTS** are designed to MIL-C-39029 and can be crimped with the standard M22520/1 crimp tool.

**CLOSED-ENTRY SOCKET CONTACTS** eliminate damage from abuse by test probes and help to correct any misaligned pins during engagement.

**CONTACT INSERTION** is accomplished from the rear of the connector.

When the contact is fully inserted, the clip tines snap securely behind the contact shoulder.

**CONTACT EXTRACTION** is accomplished with a front-inserted extraction tool. Pressing the tool plunger pushes the contact out thru the rear of the connector.

**CONTACT RETAINING CLIP** is completely encased in a tough plastic wafer to protect the clip from damage.

**COMPLETE MOISTURE SEALING** is achieved by combining four seals: shell, peripheral, interfacial and wire seals.

**SHELL SEAL** is effected when the plug shell pushes against the sealing ring in the receptacle when the connectors are mated.

**PERIPHERAL SEAL** around the edge of the pin insulator is designed so that mating the connector puts tension on the seal and greatly reduces compression set.

**INTERFACIAL SEAL** is achieved by the insulator faces meeting when the plug and receptacle are mated.

**WIRE SEAL** is accomplished by a multiple ripple design, exceeding the wire sealing requirements of MIL-C-26482.

**POSITIVE INSERT-TO-SHELL MECHANICAL RETENTION** with hard plastic wafer firmly locked into a groove in the shell, in addition to a strong adhesive bond between the insert and shell.

**Performance and Material Specifications**

**STANDARD MATERIALS AND FINISHES**

|                   |   |
|-------------------|---|
| Shell             | aluminum alloy, conductive olive drab chromate over cadmium finish per QQ-P-416 |
| Insulator         | polychloroprene   |
| Grommet and Seal  | polychloroprene   |
| Contacts          | Copper alloy, gold plate per MIL-G-45204 type II                                |
| Temperature Range | - 55°C to +125°C  |

**MECHANICAL**

|                        |  |
|------------------------|--|
| Shell Sizes            | 00 - wall mounting receptacle<br>01 - cable connecting plug<br>02 - box mounting receptacle<br>06 - straight plug<br>07 - jam nut receptacle<br>08 - 90° angle plug<br>B - thru-bulkhead receptacle (KPT only) |
| Shell Sizes            | KPT 8 thru 24<br>KPSE 10 thru 24   |
| Polarization/Coupling: | five keyway/three point bayonet  |
| Service Classes        | A - general duty<br>B - general duty with strain relief<br>E - grommet seal<br>F - grommet seal with strain relief<br>J - gland nut with strain relief for jacketed cable<br>P - potted                        |

**ELECTRICAL**

|                           |                |                        |              |                |
|---------------------------|----------------|------------------------|--------------|----------------|
| Contact Termination       | solder (KPT)   | crimp snap-in (KPSE)   |              |                |
| Number of contacts        | KPT 2 thru 61  | KPSE 3 thru 61         |              |                |
| Wire size, AWG            | KPT 12 thru 24 | KPSE 16 thru 24        |              |                |
| Wire Range Accommodations |                | Insulation O.D. Limits |              |                |
| Contact Size              | AWG Wire Size  | Min. KPT               | Min. KPSE    | Max. KPT/KPSE  |
| 20                        | 24, 22 and 20  | .060 (1.52)            | .047 (1.19)  | .083 (2.11)    |
| 16                        | 20, 18 and 16  | .066 (1.68)            | .066 (1.68)  | .109 (2.77)    |
| 12                        | 14 and 12      | .097 (2.46)            |              | .142 (3.61)    |
| Contact Rating            | Contact Size   | Rated Amps             | Test Current | Millivolt Drop |
|                           | 20             | 7.5                    | 7.5          | less than 55   |
|                           | 16             | 22.0                   | 13.0         | less than 50   |
| Service Rating            | Test Volt      | Service                | AC(rms)      | DC             |
|                           | Sea level      | 1                      | 1500         | 2100           |
|                           |                | 2                      | 2300         | 3200           |
|                           | 70,000 ft.     | 1                      | 375          | 535            |
|                           |                | 2                      | 550          | 770            |
| Maximum Operating Voltage | Sea level      | 1                      | 600          | 850            |
|                           |                | 2                      | 1000         | 1275           |

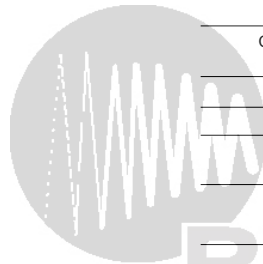

PEI-Genesis

Wall Mounting Receptacles

MS3110 (MS service class E, F, J, P)  
MS3120 (MS service class E, F, P)

KPT00  
KPSE00

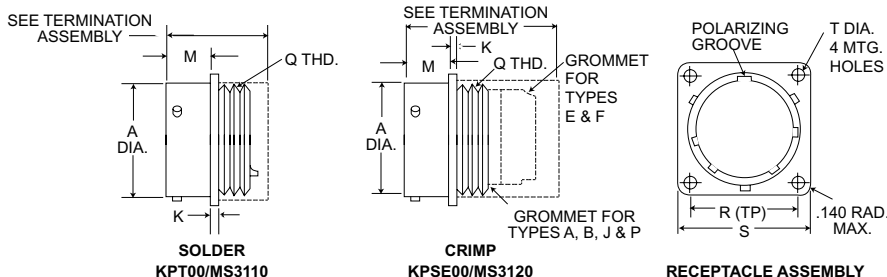

| Shell Size | A<br>± .003 (±.08) | K<br>± .016 (±.41) | M<br>+ .031 (+.79)<br>- .000 (-.00) | R*<br>(TP)    | S<br>Max.     | T<br>± .005 (±.13) | Q Thread<br>Class 2A |
|------------|--------------------|--------------------|-------------------------------------|---------------|---------------|--------------------|----------------------|
| †8         | .471 (11.96)       | .062 (1.57)        | .431 (10.95)                        | .594 (15.09)  | .828 (21.03)  | .120 (3.05)        | 7/16-28UNEF          |
| 10         | .588 (14.96)       | .062 (1.57)        | .431 (10.95)                        | .719 (18.26)  | .954 (24.23)  | .120 (3.05)        | 9/16-24UNEF          |
| 12         | .748 (19.00)       | .062 (1.57)        | .431 (10.95)                        | .812 (20.62)  | 1.047 (26.59) | .120 (3.05)        | 11/16-24UNEF         |
| 14         | .873 (22.17)       | .062 (1.57)        | .431 (10.95)                        | .906 (23.01)  | 1.141 (28.98) | .120 (3.05)        | 13/16-20UNEF         |
| 16         | .998 (25.35)       | .062 (1.57)        | .431 (10.95)                        | .969 (24.61)  | 1.234 (31.34) | .120 (3.05)        | 15/16-20UNEF         |
| 18         | 1.123 (28.52)      | .062 (1.57)        | .431 (10.95)                        | 1.062 (26.97) | 1.328 (33.73) | .120 (3.05)        | 1-1/16-18UNEF        |
| 20         | 1.248 (31.70)      | .094 (2.39)        | .556 (14.12)                        | 1.156 (29.36) | 1.453 (36.91) | .120 (3.05)        | 1-3/16-18UNEF        |
| 22         | 1.373 (34.87)      | .094 (2.39)        | .556 (14.12)                        | 1.250 (31.75) | 1.578 (40.08) | .120 (3.05)        | 1-5/16-18UNEF        |
| 24         | 1.498 (38.05)      | .094 (2.39)        | .589 (14.96)                        | 1.375 (34.92) | 1.703 (43.26) | .147 (3.73)        | 1-7/16-18UNEF        |

†Not available in KPSE \* (TP) located within .010 T.P. with respect to diameter A and master keyway.

Receptacles with Termination Assemblies

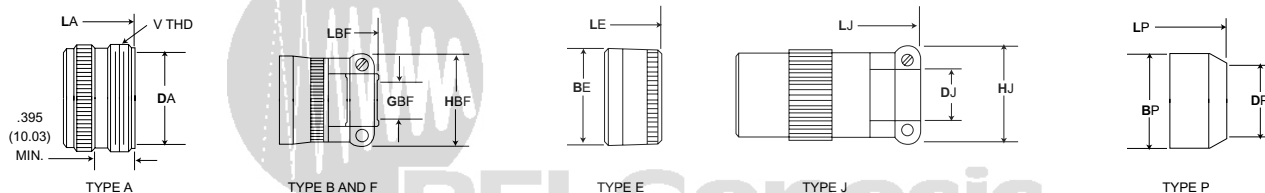

PEI-Genesis

| Shell Size | TYPE A        |               |                   | TYPE B and F |               |               | TYPE E        |               |
|------------|---------------|---------------|-------------------|--------------|---------------|---------------|---------------|---------------|
|            | DA Min.       | LA Max.       | V Thread Class 2A | GBF Min.     | HBF Max.      | LBF Max.      | BE Max.       | LE Max.       |
| †8         | .335 (8.15)   | 1.44 (36.68)  | 1/2-28UNEF        | .115 (2.92)  | .828 (21.03)  | 1.922 (48.82) | .608 (15.44)  | 1.328 (33.73) |
| 10         | .466 (11.84)  | 1.44 (36.68)  | 5/8-24UNEF        | .178 (4.52)  | .891 (22.63)  | 1.922 (48.82) | .734 (18.64)  | 1.328 (33.73) |
| 12         | .591 (15.01)  | 1.444 (36.68) | 3/4-20UNEF        | .302 (7.67)  | 1.016 (25.81) | 1.922 (48.82) | .858 (21.79)  | 1.328 (33.73) |
| 14         | .705 (19.05)  | 1.444 (36.68) | 7/8-20UNEF        | .365 (9.27)  | 1.141 (28.98) | 1.922 (48.82) | .984 (24.99)  | 1.328 (33.73) |
| 16         | .830 (21.08)  | 1.444 (36.68) | 1-20UNEF          | .490 (12.45) | 1.203 (30.56) | 2.047 (51.99) | 1.110 (28.19) | 1.328 (33.73) |
| 18         | .948 (24.08)  | 1.444 (36.68) | 1-3/16-18UNEF     | .615 (15.62) | 1.469 (37.31) | 2.078 (52.78) | 1.234 (31.34) | 1.328 (33.73) |
| 20         | 1.043 (26.49) | 1.728 (43.89) | 1-3/16-18UNEF     | .615 (15.62) | 1.469 (37.31) | 2.344 (59.54) | 1.360 (34.54) | 1.531 (38.89) |
| 22         | 1.198 (30.43) | 1.728 (43.89) | 1-7/16-18UNEF     | .740 (18.80) | 1.656 (42.06) | 1.344 (59.54) | 1.484 (37.69) | 1.531 (38.89) |
| 24         | 1.293 (32.84) | 1.738 (44.15) | 1-7/16-18UNEF     | .790 (20.07) | 1.750 (44.45) | 2.406 (61.11) | 1.610 (40.89) | 1.594 (40.49) |

| Shell Size | TYPE J                  |               |                | TYPE P        |               |               |
|------------|-------------------------|---------------|----------------|---------------|---------------|---------------|
|            | DJ Max./Min.            | HJ Max.       | LJ Max.        | BP Max.       | DP Min.       | LP Max.       |
| †8         | .230/.168 (5.84/4.27)   | .828 (21.03)  | 2.271 (57.68)  | .608 (15.44)  | .317 (8.05)   | 1.453 (36.91) |
| 10         | .312/.205 (7.92/5.21)   | .891 (22.63)  | 2.271 (57.68)  | .734 (18.64)  | .434 (11.02)  | 1.453 (36.91) |
| 12         | .442/.338 (11.23/8.59)  | 1.016 (25.81) | 2.411 (61.24)  | .858 (21.79)  | .548 (13.92)  | 1.453 (36.91) |
| 14         | .539/.416 (13.56/10.57) | 1.141 (28.98) | 2.599 (66.01)  | .984 (24.99)  | .673 (17.09)  | 1.453 (36.91) |
| 16         | .616/.550 (15.65/13.97) | 1.203 (30.56) | 2.943 (74.75)  | 1.110 (28.19) | .798 (20.27)  | 1.453 (36.91) |
| 18         | .672/.600 (17.07/15.24) | 1.469 (37.31) | 3.172 (80.57)  | 1.234 (31.34) | .899 (22.83)  | 1.453 (36.91) |
| 20         | .747/.634 (18.97/16.13) | 1.469 (37.31) | 3.610 (91.69)  | 1.360 (34.54) | 1.024 (26.01) | 1.672 (42.47) |
| 22         | .846/.670 (21.49/17.02) | 1.656 (42.06) | 3.766 (95.66)  | 1.484 (37.69) | 1.149 (29.18) | 1.672 (42.47) |
| 24         | .894/.740 (22.71/18.80) | 1.750 (44.45) | 3.985 (101.22) | 1.610 (40.89) | 1.274 (32.36) | 1.734 (44.04) |

Performance Specifications - Page 142  
Contacts, Sealing Plugs, Assembly Tools - Page 154  
Contact Arrangements - Page 149

†Not available in KPSE

Cable Connecting Plugs

MS3111  
(MS service class E, F, J, P)  
MS3121  
(MS service class E, F, P)

KPT01  
KPSE01

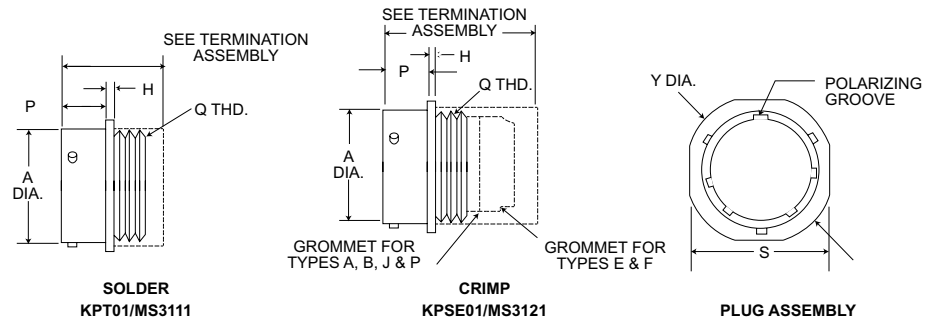

| Shell Size | A<br>± .003 (±.08) | H<br>± .016 (±.41) | P<br>+ .031 (+.79)<br>- .000 (-.00) | S<br>Max.     | Y<br>Max.     | Q Thread<br>Class 2A |
|------------|--------------------|--------------------|-------------------------------------|---------------|---------------|----------------------|
| †8         | .471 (11.96)       | .094 (2.39)        | .400 (10.16)                        | .828 (21.03)  | .958 (24.33)  | 7/16-28UNEF          |
| 10         | .588 (14.94)       | .094 (2.39)        | .400 (10.16)                        | .954 (24.23)  | 1.082 (27.48) | 9/16-24UNEF          |
| 12         | .748 (19.00)       | .094 (2.39)        | .400 (10.16)                        | 1.047 (26.59) | 1.176 (29.87) | 11/16-24UNEF         |
| 14         | .873 (22.17)       | .094 (2.39)        | .400 (10.16)                        | 1.141 (28.98) | 1.270 (32.26) | 13/16-20UNEF         |
| 16         | .998 (25.35)       | .094 (2.39)        | .400 (10.16)                        | 1.234 (31.34) | 1.364 (34.65) | 15/16-20UNEF         |
| 18         | 1.123 (28.52)      | .094 (2.39)        | .400 (10.16)                        | 1.328 (33.73) | 1.458 (37.03) | 1-1/16-18UNEF        |
| 20         | 1.248 (31.70)      | .115 (2.92)        | .535 (13.59)                        | 1.453 (36.91) | 1.582 (40.18) | 1-3/16-18UNEF        |
| 22         | 1.373 (34.87)      | .115 (2.92)        | .535 (13.59)                        | 1.578 (40.08) | 1.708 (43.38) | 1-5/16-18UNEF        |
| 24         | 1.498 (38.05)      | .115 (2.92)        | .558 (14.43)                        | 1.703 (43.26) | 1.832 (46.53) | 1-7/16-18UNEF        |

†Not available in KPSE \*(TP) located within .010T.P. with respect to diameters A and master keyway.

Cable Connecting Plugs With Termination Assemblies

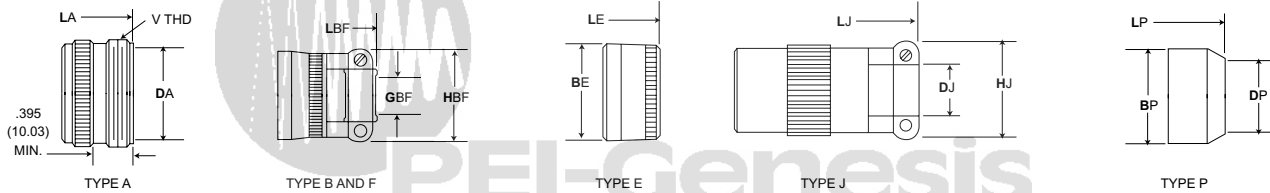

With Termination Assemblies

| Shell Size | TYPE A        |               |                   | TYPE B and F |               |               | TYPE E        |               |
|------------|---------------|---------------|-------------------|--------------|---------------|---------------|---------------|---------------|
|            | DA Min.       | LA Max.       | V Thread Class 2A | GBF Min.     | HBF Max.      | LBF Max.      | BE Max.       | LE Max.       |
| †8         | .335 (8.15)   | 1.44 (36.68)  | 1/2-28UNEF        | .115 (2.92)  | .828 (21.03)  | 1.922 (48.82) | .608 (15.44)  | 1.328 (33.73) |
| 10         | .466 (11.84)  | 1.44 (36.68)  | 5/8-24UNEF        | .178 (4.52)  | .891 (22.63)  | 1.922 (48.82) | .734 (18.64)  | 1.328 (33.73) |
| 12         | .591 (15.01)  | 1.44 (36.68)  | 3/4-20UNEF        | .302 (7.67)  | 1.016 (25.81) | 1.922 (48.82) | .858 (21.79)  | 1.328 (33.73) |
| 14         | .705 (19.05)  | 1.44 (36.68)  | 7/8-20UNEF        | .365 (9.27)  | 1.141 (28.98) | 1.922 (48.82) | .984 (24.99)  | 1.328 (33.73) |
| 16         | .830 (21.08)  | 1.44 (36.68)  | 1-20UNEF          | .490 (12.45) | 1.203 (30.56) | 2.047 (51.99) | 1.110 (28.19) | 1.328 (33.73) |
| 18         | .948 (24.08)  | 1.44 (36.68)  | 1-3/16-18UNEF     | .615 (15.62) | 1.469 (37.31) | 2.078 (52.78) | 1.234 (31.34) | 1.328 (33.73) |
| 20         | 1.043 (26.49) | 1.728 (43.89) | 1-3/16-18UNEF     | .615 (15.62) | 1.469 (37.31) | 2.344 (59.54) | 1.360 (34.54) | 1.531 (38.89) |
| 22         | 1.198 (30.43) | 1.728 (43.89) | 1-7/16-18UNEF     | .740 (18.80) | 1.656 (42.06) | 1.344 (59.54) | 1.484 (37.69) | 1.531 (38.89) |
| 24         | 1.293 (32.84) | 1.738 (44.15) | 1-7/16-18UNEF     | .790 (20.07) | 1.750 (44.45) | 2.406 (61.11) | 1.610 (40.89) | 1.594 (40.49) |

| Shell Size | TYPE J                  |               |                | TYPE P        |               |               |
|------------|-------------------------|---------------|----------------|---------------|---------------|---------------|
|            | DJ Max./Min.            | HJ Max.       | LJ Max.        | BP Max.       | DP Min.       | LP Max.       |
| †8         | .230/.168 (5.84/4.27)   | .828 (21.03)  | 2.271 (57.68)  | .608 (15.44)  | .317 (8.05)   | 1.453 (36.91) |
| 10         | .312/.205 (7.92/5.21)   | .891 (22.63)  | 2.271 (57.68)  | .734 (18.64)  | .434 (11.02)  | 1.453 (36.91) |
| 12         | .442/.338 (11.23/8.59)  | 1.016 (25.81) | 2.411 (61.24)  | .858 (21.79)  | .548 (13.92)  | 1.453 (36.91) |
| 14         | .539/.416 (13.56/10.57) | 1.141 (28.98) | 2.599 (66.01)  | .984 (24.99)  | .673 (17.09)  | 1.453 (36.91) |
| 16         | .616/.550 (15.65/13.97) | 1.203 (30.56) | 2.943 (74.75)  | 1.110 (28.19) | .798 (20.27)  | 1.453 (36.91) |
| 18         | .672/.600 (17.07/15.24) | 1.469 (37.31) | 3.172 (80.57)  | 1.234 (31.34) | .899 (22.83)  | 1.453 (36.91) |
| 20         | .747/.634 (18.97/16.13) | 1.469 (37.31) | 3.610 (91.69)  | 1.360 (34.54) | 1.024 (26.01) | 1.672 (42.47) |
| 22         | .846/.670 (21.49/17.02) | 1.656 (42.06) | 3.766 (95.66)  | 1.484 (37.69) | 1.149 (29.18) | 1.672 (42.47) |
| 24         | .894/.740 (22.71/18.80) | 1.750 (44.45) | 3.985 (101.22) | 1.610 (40.89) | 1.274 (32.36) | 1.734 (44.04) |

†Not available in KPSE

Performance Specifications - Page 142  
Contacts, Sealing Plugs, Assembly Tools - Page 154

Contact Arrangements - Page 149

Box Mounting Receptacles

MS3112  
(MS service class E)  
MS3122  
(MS service class E)

KPT02  
KPSE02

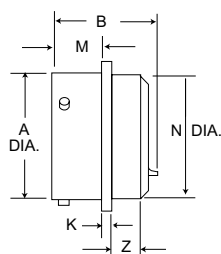

SOLDER  
KPT02/MS3112

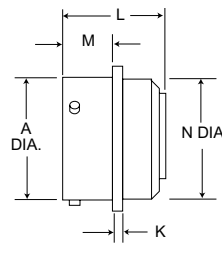

CRIMP  
KPSE02/MS3122

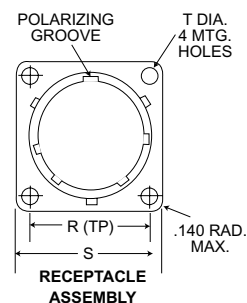

RECEPTACLE  
ASSEMBLY

Note: Connector does not accommodate backshell.

| Shell Size | A ± .003 (±.08) | B Max         | K ± .016 (±.41) | L Max.        | M + .031 (+.79) - .000 (-.00) | N Dia. Max.   | R* (TP)       | S Max.        | T ± .005    | Z Max.       |
|------------|-----------------|---------------|-----------------|---------------|-------------------------------|---------------|---------------|---------------|-------------|--------------|
| †8         | .471 (11.96)    | .978 (12.14)  | .062 (1.57)     | 1.320 (33.07) | .431 (10.95)                  | .469 (11.91)  | .594 (15.09)  | .828 (21.03)  | .120 (3.05) | .354 (8.99)  |
| 10         | .588 (14.96)    | .978 (12.14)  | .062 (1.57)     | 1.320 (33.07) | .431 (10.95)                  | .593 (15.06)  | .719 (18.26)  | .954 (24.23)  | .120 (3.05) | .354 (8.99)  |
| 12         | .748 (19.00)    | .978 (12.14)  | .062 (1.57)     | 1.320 (33.07) | .431 (10.95)                  | .719 (18.26)  | .812 (20.62)  | 1.047 (26.59) | .120 (3.05) | .354 (8.99)  |
| 14         | .873 (22.17)    | .978 (12.14)  | .062 (1.57)     | 1.320 (33.07) | .431 (10.95)                  | .843 (21.41)  | .906 (23.01)  | 1.141 (28.98) | .120 (3.05) | .354 (8.99)  |
| 16         | .998 (25.35)    | .978 (12.14)  | .062 (1.57)     | 1.320 (33.07) | .431 (10.95)                  | .969 (24.61)  | .969 (24.61)  | 1.234 (31.34) | .120 (3.05) | .354 (8.99)  |
| 18         | 1.123 (28.52)   | .978 (12.14)  | .062 (1.57)     | 1.320 (33.07) | .431 (10.95)                  | 1.093 (27.76) | 1.062 (26.97) | 1.328 (33.73) | .120 (3.05) | .354 (8.99)  |
| 20         | 1.248 (31.70)   | 1.196 (30.38) | .094 (2.39)     | 1.367 (34.72) | .556 (14.12)                  | 1.219 (30.96) | 1.156 (29.36) | 1.453 (36.91) | .120 (3.05) | .417 (10.59) |
| 22         | 1.373 (34.87)   | 1.196 (30.38) | .094 (2.39)     | 1.367 (34.72) | .556 (14.12)                  | 1.343 (34.11) | 1.250 (31.75) | 1.578 (40.08) | .120 (3.05) | .417 (10.59) |
| 24         | 1.498 (38.05)   | 1.196 (30.98) | .094 (2.39)     | 1.418 (36.02) | .589 (14.96)                  | 1.469 (37.31) | 1.375 (34.92) | 1.703 (43.26) | .147 (3.73) | .445 (11.30) |

†Not available in KPSE \*(TP) located within .010T.P. with respect to diameter A and master keyway.

Thru-Bulkhead Receptacles

MS3119  
(MS service class E)

KPTB

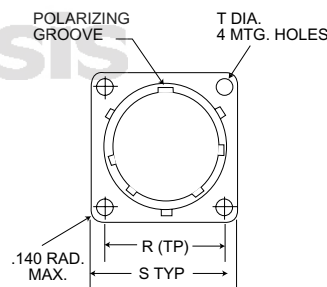
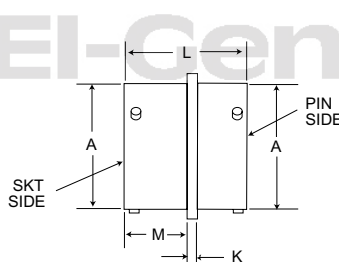

\*(T.P) located within .010 T.P. with respect to diameter A and master keyway.

| Shell Size | A Dia. ± .003 (±.08) | K ± .016 (±.406) | L Max.        | M + .031 (+.79) - .000 (-.00) | R* (TP)       | S Max.        | T ± .005 (± .127) |
|------------|----------------------|------------------|---------------|-------------------------------|---------------|---------------|-------------------|
| †8         | .471 (11.96)         | .062 (1.57)      | 1.125 (28.58) | .562 (14.27)                  | .594 (15.09)  | .828 (21.03)  | .120 (3.05)       |
| 10         | .588 (14.94)         | .062 (1.57)      | 1.125 (28.58) | .562 (14.27)                  | .719 (18.26)  | .954 (24.23)  | .120 (3.05)       |
| 12         | .748 (18.00)         | .062 (1.57)      | 1.125 (28.58) | .562 (14.27)                  | .812 (20.62)  | 1.047 (26.59) | .120 (3.05)       |
| 14         | .873 (22.17)         | .062 (1.57)      | 1.125 (28.58) | .562 (14.27)                  | .906 (23.01)  | 1.141 (28.98) | .120 (3.05)       |
| 16         | .998 (25.35)         | .062 (1.57)      | 1.125 (28.58) | .562 (14.27)                  | .969 (24.61)  | 1.234 (31.34) | .120 (3.05)       |
| 18         | 1.123 (28.52)        | .062 (1.57)      | 1.125 (28.58) | .562 (14.27)                  | 1.062 (26.97) | 1.328 (33.73) | .120 (3.05)       |
| 20         | 1.248 (31.70)        | .094 (2.39)      | 1.406 (35.71) | .688 (17.48)                  | 1.156 (29.36) | 1.453 (36.91) | .120 (3.05)       |
| 22         | 1.373 (34.87)        | .094 (2.39)      | 1.406 (35.71) | .688 (17.48)                  | 1.250 (31.76) | 1.578 (40.08) | .120 (3.05)       |
| 24         | 1.498 (38.05)        | .094 (2.39)      | 1.406 (35.71) | .688 (17.48)                  | 1.375 (34.92) | 1.703 (43.26) | .147 (3.73)       |

Performance Specifications - Page 142  
Contacts, Sealing Plugs, Assembly Tools - Page 154  
Contact Arrangements - Page 149

**Straight Plugs**

MS3116  
(MS service class E, F, J, P)  
MS3126  
(MS service class E, F, P)

KPT06  
KPSE06

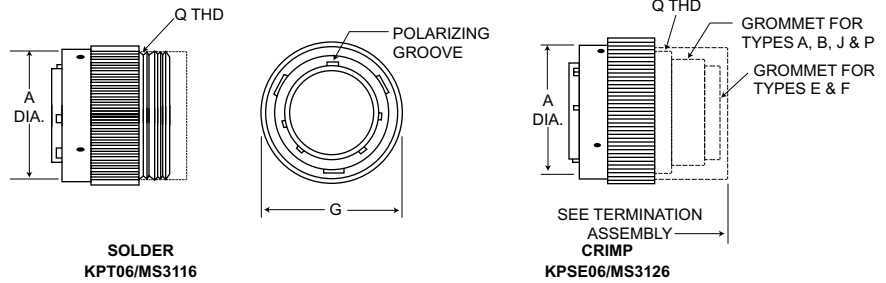

| Shell Size | A dia. Max.   | G Max.        | J ± .010 (±0.25) | Q Thread Class 2A |
|------------|---------------|---------------|------------------|-------------------|
| †8         | .765 (19.43)  | .782 (19.86)  | .353 (8.99)      | 7/16-28UNEF       |
| 10         | .840 (21.34)  | .926 (23.52)  | .353 (8.99)      | 9/16-24UNEF       |
| 12         | .999 (25.38)  | 1.043 (26.49) | .353 (8.99)      | 11/16-24UNEF      |
| 14         | 1.139 (28.93) | 1.183 (30.05) | .353 (8.99)      | 13/16-20UNEF      |
| 16         | 1.261 (32.03) | 1.305 (33.15) | .353 (8.99)      | 15/16-20UNEF      |
| 18         | 1.337 (33.96) | 1.391 (35.33) | .353 (8.99)      | 1-1/16-18UNEF     |
| 20         | 1.477 (37.52) | 1.531 (38.89) | .415 (10.54)     | 1-3/16-18UNEF     |
| 22         | 1.602 (40.69) | 1.656 (42.06) | .415 (10.54)     | 1-5/16-18UNEF     |
| 24         | 1.723 (43.76) | 1.77 (45.14)  | .415 (10.54)     | 1-7/16-18UNEF     |

†Not available in KPSE

**Straight Plugs With Termination Assemblies**

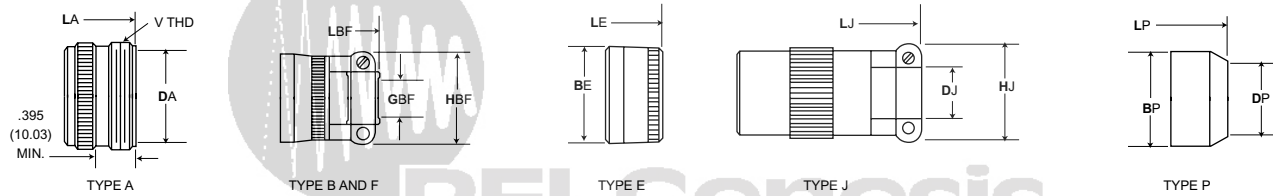

| Shell Size | TYPE A        |               |                   | TYPE B and F  |               |              | TYPE E        |               |
|------------|---------------|---------------|-------------------|---------------|---------------|--------------|---------------|---------------|
|            | LA Max.       | DA Min.       | V Thread Class 2A | LBF Max.      | HBF Max.      | GBF Min.     | BE Max.       | LE Max.       |
| †8         | 1.440 (36.58) | .335 (8.51)   | 1/2-28UNEF        | 1.906 (48.41) | .828 (21.03)  | .115 (2.02)  | .608 (15.44)  | 1.328 (33.73) |
| 10         | 1.440 (36.58) | .466 (11.84)  | 5/8-24UNEF        | 1.906 (48.41) | .891 (22.63)  | .178 (4.52)  | .734 (18.64)  | 1.328 (33.73) |
| 12         | 1.440 (36.58) | .591 (15.01)  | 3/4-20UNEF        | 1.906 (48.41) | 1.016 (25.81) | .302 (7.67)  | .858 (21.79)  | 1.328 (33.73) |
| 14         | 1.440 (36.58) | .705 (19.05)  | 7/8-20UNEF        | 1.906 (48.41) | 1.141 (28.98) | .365 (9.27)  | .984 (24.99)  | 1.328 (33.73) |
| 16         | 1.440 (36.58) | .830 (21.08)  | 1-20UNEF          | 2.047 (51.99) | 1.203 (30.56) | .490 (12.45) | 1.110 (28.19) | 1.328 (33.73) |
| 18         | 1.662 (42.21) | .948 (24.08)  | 1-3/16-18UNEF     | 2.078 (52.78) | 1.469 (37.31) | .615 (15.62) | 1.234 (31.34) | 1.328 (33.73) |
| 20         | 1.662 (42.21) | 1.043 (26.49) | 1-3/16-18UNEF     | 2.250 (57.15) | 1.469 (37.31) | .615 (15.62) | 1.360 (34.54) | 1.453 (36.91) |
| 22         | 1.662 (42.21) | 1.198 (30.43) | 1-7/16-18UNEF     | 2.250 (57.15) | 1.656 (42.06) | .740 (18.80) | 1.484 (37.69) | 1.453 (36.91) |
| 24         | 1.672 (42.47) | 1.293 (32.84) | 1-7/16-18UNEF     | 2.312 (58.72) | 1.750 (44.45) | .790 (20.07) | 1.610 (40.89) | 1.510 (38.54) |

| Shell Size | TYPE J         |               |                         | TYPE P        |               |               |
|------------|----------------|---------------|-------------------------|---------------|---------------|---------------|
|            | LJ Max.        | HJ Max.       | DJ Max./Min.            | LP Max.       | DP Min.       | BP Max.       |
| †8         | 2.271 (57.68)  | .828 (21.03)  | .230/.168 (5.84/4.27)   | 1.500 (38.10) | .317 (8.05)   | .608 (15.44)  |
| 10         | 2.271 (57.68)  | .891 (22.63)  | .312/.205 (7.92/5.21)   | 1.500 (38.10) | .434 (11.02)  | .734 (18.64)  |
| 12         | 2.411 (61.24)  | 1.016 (25.81) | .442/.338 (11.23/8.59)  | 1.500 (38.10) | .548 (13.92)  | .858 (21.79)  |
| 14         | 2.599 (66.01)  | 1.141 (28.98) | .539/.416 (13.56/10.57) | 1.500 (38.10) | .673 (17.09)  | .984 (24.99)  |
| 16         | 2.943 (74.75)  | 1.203 (30.56) | .616/.550 (15.65/13.97) | 1.500 (38.10) | .798 (20.27)  | 1.110 (28.19) |
| 18         | 3.172 (80.57)  | 1.469 (37.31) | .672/.600 (17.07/15.24) | 1.500 (38.10) | .899 (22.83)  | 1.234 (31.34) |
| 20         | 3.610 (91.69)  | 1.469 (37.31) | .747/.634 (18.97/16.13) | 1.609 (40.87) | 1.024 (26.01) | 1.360 (34.54) |
| 22         | 3.766 (95.66)  | 1.656 (42.06) | .846/.670 (21.49/17.02) | 1.609 (40.87) | 1.149 (29.18) | 1.484 (37.69) |
| 24         | 3.985 (101.22) | 1.750 (44.45) | .894/.740 (22.71/18.80) | 1.687 (42.85) | 1.274 (32.36) | 1.610 (40.89) |

†Not available in KPSE

Performance Specifications - Page 142  
Contacts, Sealing Plugs, Assembly Tools - Page 154  
Contact Arrangements - Page 149

Jam Nut Receptacles

MS3114  
(MS service class E, F, P)  
MS3124  
(MS service class E, F, P)

KPT07

KPSE07

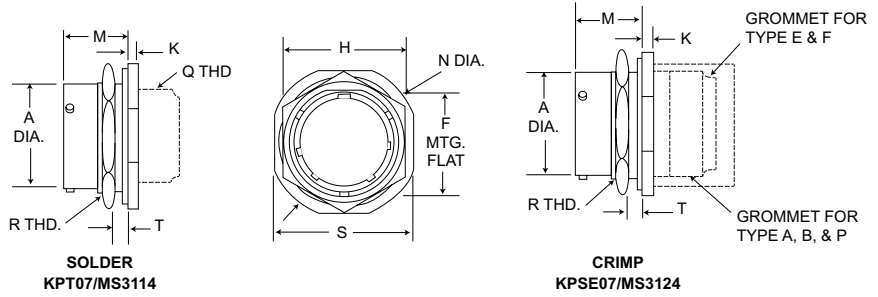

| Shell Size | A             |               | H             | K           | M             |               | N Max.        | S Max.      | T                              |                      | R thread Class 2A |
|------------|---------------|---------------|---------------|-------------|---------------|---------------|---------------|-------------|--------------------------------|----------------------|-------------------|
|            | ±.003 (±0.08) | ±.005 (0.130) |               |             | ±.017 (±0.43) | ±.020 (±.05)  |               |             | +0.031 (+.08)<br>-0.000 (-.00) | Panel Thickness Min. |                   |
| †8         | .471 (11.96)  | .525 (13.34)  | .750 (19.05)  | .117 (2.97) | .691 (17.55)  | 1.078 (27.38) | .954 (24.23)  | .062 (1.57) | .125 (3.17)                    | 9/16-24UNEF          |                   |
| 10         | .588 (14.93)  | .650 (16.51)  | .875 (22.22)  | .117 (2.97) | .691 (17.55)  | 1.206 (30.56) | 1.078 (27.38) | .062 (1.57) | .125 (3.17)                    | 11/16-24UNEF         |                   |
| 12         | .748 (19.00)  | .813 (20.65)  | 1.062 (26.97) | .117 (2.97) | .691 (17.55)  | 1.319 (35.33) | 1.266 (32.16) | .062 (1.57) | .125 (3.17)                    | 7/8-20UNEF           |                   |
| 14         | .873 (22.17)  | .937 (23.80)  | 1.188 (30.17) | .117 (2.97) | .691 (17.55)  | 1.516 (38.51) | 1.391 (35.33) | .062 (1.57) | .125 (3.17)                    | 1-20UNEF             |                   |
| 16         | .988 (25.35)  | 1.061 (26.95) | 1.312 (33.32) | .117 (2.97) | .691 (17.55)  | 1.641 (41.68) | 1.516 (38.51) | .062 (1.57) | .125 (3.17)                    | 1-1/8-18UNEF         |                   |
| 18         | 1.123 (28.52) | 1.186 (30.12) | 1.438 (36.25) | .117 (2.97) | .691 (17.55)  | 1.766 (44.86) | 1.41 (41.68)  | .062 (1.57) | .125 (3.17)                    | 1-1/4-18UNEF         |                   |
| 20         | 1.248 (31.70) | 1.311 (33.30) | 1.562 (39.67) | .148 (3.76) | .879 (22.33)  | 1.954 (49.63) | 1.828 (46.43) | .062 (1.57) | .250 (6.35)                    | 1-3/8-18UNEF         |                   |
| 22         | 1.373 (34.87) | 1.436 (36.47) | 1.688 (42.87) | .148 (3.76) | .879 (22.33)  | 2.078 (52.78) | 1.954 (49.63) | .062 (1.57) | .250 (6.35)                    | 1-1/2-18UNEF         |                   |
| 24         | 1.498 (38.05) | 1.561 (39.65) | 1.812 (46.02) | .148 (3.76) | .912 (23.16)  | 2.203 (55.96) | 2.078 (52.78) | .062 (1.57) | .250 (6.35)                    | 1-5/8-18UNEF         |                   |

†Not available in KPSE

Jam Nut Receptacles With Termination Assemblies

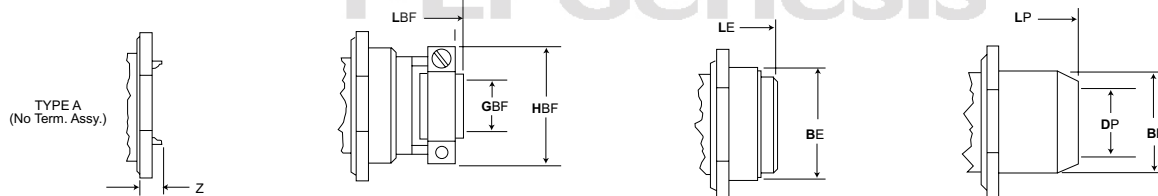

| Shell Size | TYPE A      | TYPE B AND F  |              |               | TYPE E        |               | TYPE P        |               |               |
|------------|-------------|---------------|--------------|---------------|---------------|---------------|---------------|---------------|---------------|
|            | Z Max.      | HBF Max.      | GBF Min.     | LBF Max.      | BE Max.       | LE Max.       | BP Max.       | DP Min.       | LP Max.       |
| †8         | .312 (7.92) | .828 (21.03)  | .115 (2.02)  | 1.906 (48.41) | .608 (15.44)  | 1.344 (34.14) | .608 (15.44)  | .317 (8.05)   | 1.391 (35.33) |
| 10         | .312 (7.92) | .891 (22.63)  | .178 (4.52)  | 1.906 (48.41) | .734 (18.64)  | 1.344 (34.14) | .734 (18.64)  | .434 (11.02)  | 1.391 (35.33) |
| 12         | .312 (7.92) | 1.016 (25.81) | .302 (7.67)  | 1.906 (48.41) | .858 (21.79)  | 1.344 (34.14) | .858 (21.79)  | .548 (13.92)  | 1.391 (35.33) |
| 14         | .312 (7.92) | 1.141 (28.98) | .365 (9.27)  | 1.906 (48.41) | .984 (24.99)  | 1.344 (34.14) | .984 (24.99)  | .673 (17.09)  | 1.391 (35.33) |
| 16         | .312 (7.92) | 1.203 (30.56) | .490 (12.45) | 2.047 (51.99) | 1.110 (28.19) | 1.344 (34.14) | 1.110 (28.19) | .798 (20.27)  | 1.391 (35.33) |
| 18         | .312 (7.92) | 1.469 (37.31) | .615 (15.62) | 2.078 (52.78) | 1.234 (31.34) | 1.344 (34.14) | 1.234 (31.34) | .899 (22.83)  | 1.391 (35.33) |
| 20         | 1.93 (4.90) | 1.469 (37.31) | .615 (15.62) | 2.328 (59.13) | 1.360 (34.54) | 1.594 (40.49) | 1.360 (34.54) | 1.024 (26.01) | 1.641 (41.68) |
| 22         | 1.93 (4.90) | 1.656 (42.06) | .740 (18.80) | 2.328 (59.13) | 1.484 (37.69) | 1.594 (40.49) | 1.484 (37.69) | 1.149 (29.18) | 1.641 (41.68) |
| 24         | .150 (3.81) | 1.750 (44.45) | .790 (20.07) | 2.453 (62.31) | 1.610 (40.89) | 1.641 (41.68) | 1.610 (40.89) | 1.274 (32.36) | 1.703 (43.26) |

Performacne Specifications - Page 142

Contacts, Sealing Plugs, Assembly Tools - Page 154

Contact Arrangements - Page 149

Right Angle Plugs

KPT08/KPSE08

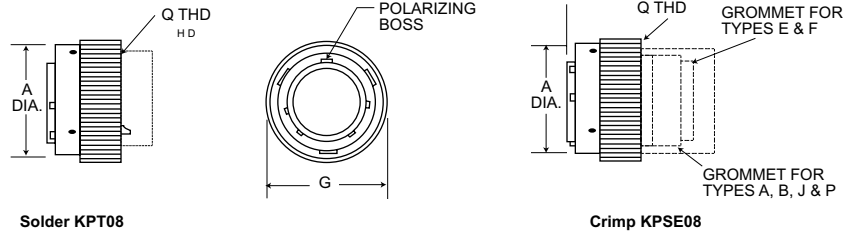

| Shell Size | KPT/KPSE      |               | Q Thread Class 2A |
|------------|---------------|---------------|-------------------|
|            | A Dia. Max.   | G Max.        |                   |
| †8         | .765 (19.43)  | .782 (19.86)  | 7/16-28UNEF       |
| 10         | .840 (21.34)  | .926 (23.52)  | 9/16-24UNEF       |
| 12         | .999 (25.38)  | 1.043 (26.49) | 11/16-24UNEF      |
| 14         | 1.139 (28.93) | 1.183 (30.05) | 13/16-20UNEF      |
| 16         | 1.261 (32.03) | 1.305 (33.15) | 15/16-20UNEF      |
| 18         | 1.337 (33.96) | 1.391 (35.33) | 1-1/16-18UNEF     |
| 20         | 1.477 (37.52) | 1.531 (38.89) | 1-3/16-18UNEF     |
| 22         | 1.602 (40.69) | 1.656 (42.09) | 1-5/16-18UNEF     |
| 24         | 1.723 (43.76) | 1.777 (45.13) | 1-7/16-18UNEF     |

†Not available in KPSE.  
 NOTE: for size 10 and 24 consult factory for availability in type A, B, E and F,  
 For size 8 consult factory for availability in Type P.

Right Angle Plugs With Termination Assemblies

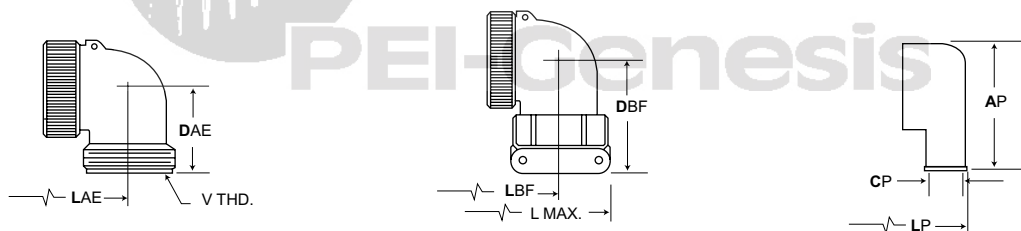

| Shell Size | TYPE A AND E  |               |                   | TYPE B AND F  |               |               |                   | TYPE P        |               |              |                   |
|------------|---------------|---------------|-------------------|---------------|---------------|---------------|-------------------|---------------|---------------|--------------|-------------------|
|            | LAE Max.      | DAE Max.      | V Thread Class 2A | DBF Max.      | LBF Max.      | L Max.        | V Thread Class 2A | AP Max.       | LP Max.       | CP Min.      | V Thread Class 2A |
| †8         | 1.421 (36.09) | .822 (20.88)  | 1/2-28UNEF        | 1.238 (31.44) | 1.421 (36.09) | 1.842 (46.79) | 1/2-28UNEF        | -(-)          | -(-)          | -(-)         | 1/2-28UNEF        |
| 10         | 1.484 (37.69) | .853 (21.67)  | 5/8-28UNEF        | 1.269 (32.24) | 1.484 (37.69) | 1.937 (49.20) | 5/8-28UNEF        | 1.030 (26.16) | 1.380 (35.05) | .252 (6.40)  | 5/8-28UNEF        |
| 12         | 1.546 (39.27) | .916 (23.27)  | 3/4-20UNEF        | 1.395 (35.43) | 1.546 (39.27) | 1.937 (49.20) | 3/4-20UNEF        | 1.030 (26.16) | 1.567 (39.80) | .252 (6.40)  | 3/4-20UNEF        |
| 14         | 1.577 (40.05) | .978 (24.84)  | 7/8-20UNEF        | 1.519 (38.58) | 1.577 (40.05) | 2.124 (53.95) | 7/8-20UNEF        | 1.030 (26.16) | 1.567 (39.80) | .283 (7.19)  | 7/8-20UNEF        |
| 16         | 1.609 (40.87) | 1.041 (26.44) | 1-20UNEF          | 1.582 (40.18) | 1.609 (40.87) | 2.203 (55.96) | 1-20UNEF          | 1.280 (32.51) | 1.567 (39.80) | .355 (9.02)  | 1-20UNEF          |
| 18         | 1.734 (44.04) | 1.103 (28.70) | 1-3/16-18UNEF     | 1.644 (41.76) | 1.734 (44.04) | 2.380 (60.45) | 1-3/16-18UNEF     | 1.280 (32.51) | 1.755 (44.58) | .530 (13.46) | 1-3/16-18UNEF     |
| 20         | 1.879 (47.73) | 1.166 (29.62) | 1-5/16-18UNEF     | 1.707 (43.36) | 1.879 (47.73) | 2.629 (66.78) | 1-5/16-18UNEF     | 1.530 (38.86) | 1.782 (45.26) | .562 (14.27) | 1-5/16-18UNEF     |
| 22         | 2.035 (51.69) | 1.245 (31.62) | 1-7/16-18UNEF     | 1.884 (47.85) | 2.035 (51.69) | 2.629 (66.78) | 1-7/16-18UNEF     | 1.530 (38.86) | 1.782 (45.26) | .562 (14.27) | 1-7/16-18UNEF     |
| 24         | 2.035 (51.69) | 1.322 (33.58) | 1-7/16-18UNEF     | 1.963 (49.86) | 2.035 (51.69) | 2.895 (73.53) | 1-7/16-18UNEF     | 1.780 (45.21) | 2.087 (53.01) | .610 (15.49) | 1-7/16-18UNEF     |

†Not available in KPSE. NOTE: For size 10 and 24 consult factory for availability in type A, B, E and F, For size 8 consult factory for availability in Type P.

Performance Specifications - Page 142  
 Contacts, Sealing Plugs, Assembly Tools - Page 154  
 Contact Arrangements - Page 149

## Contact Arrangements

### LEGEND

- ▲ KPT
- ◆ KPSE
- △ Authorized per MIL-C-26482 (NAVY)
- Not MS approved ITTC proprietary

Drawing not to scale; face view of pin insert shown (socket view is opposite)

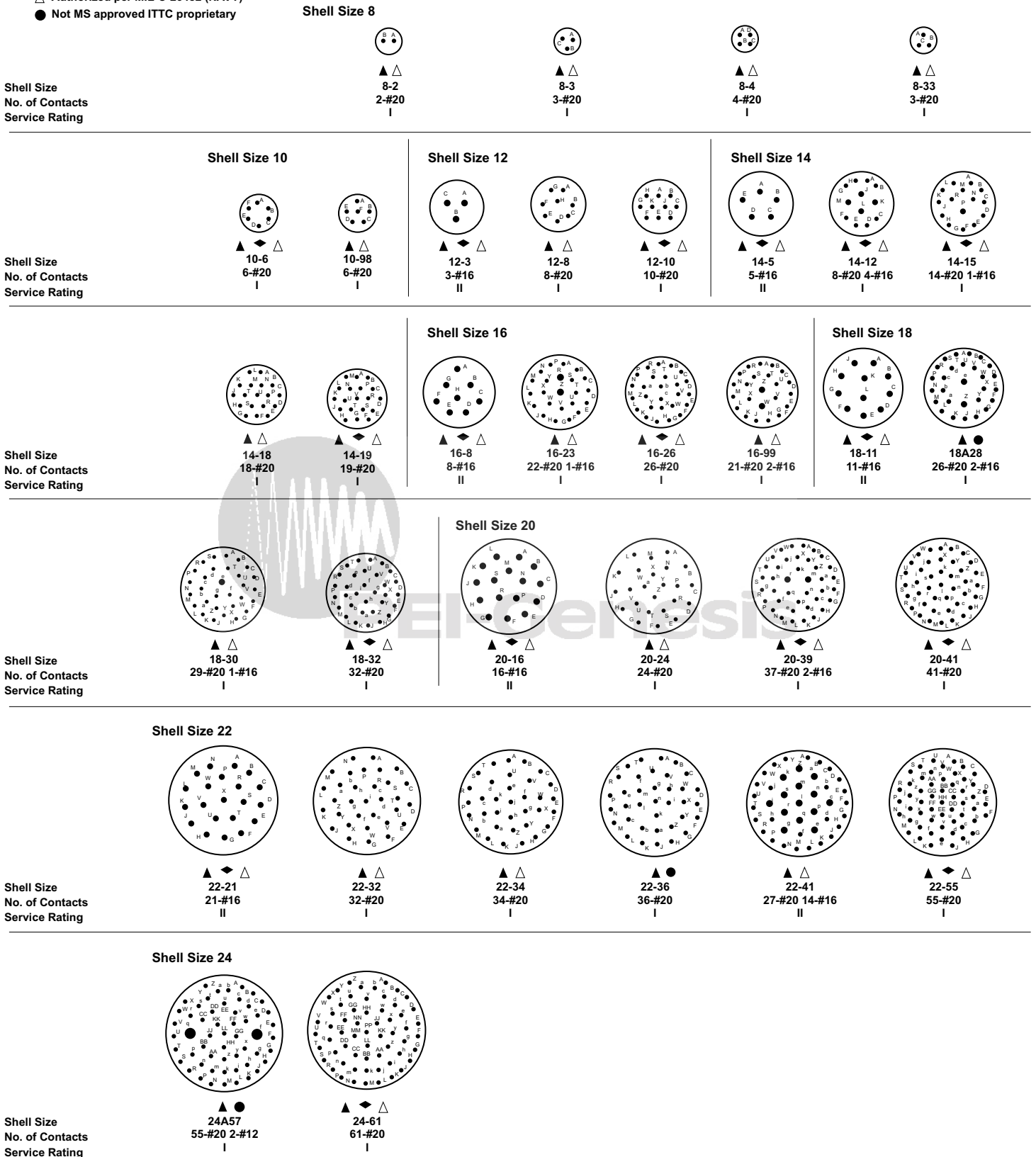

(See page 150 for Alternate Insert Positions.)

## Alternate Insert Positions

Face view of pin inserts

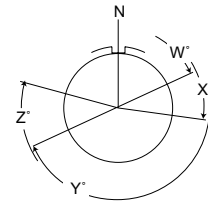

The five positions (W, X, Y, Z and Normal) differ in degree of rotation for various sizes and arrangements.

| NO. OF CONTACTS | SHELL SIZE | ARR. NO. | W   | Degrees of Rotation |     |     |  |
|-----------------|------------|----------|-----|---------------------|-----|-----|--|
|                 |            |          |     | X                   | Y   | Z   |  |
| 2               | 8          | 8-2      | 58  | 122                 | -   | -   |  |
|                 | 8          | 8-3      | 60  | 210                 | -   | -   |  |
| 3               | 8          | 8-33     | 90  | -                   | -   | -   |  |
|                 | 12         | 12-3     | -   | -                   | 180 | -   |  |
| 4               | 8          | 8-4      | 45  | -                   | -   | -   |  |
| 5               | 14         | 14-5     | 40  | 92                  | 184 | 273 |  |
| 6               | 10         | 10-6     | 90  | -                   | -   | -   |  |
|                 | 10         | 10-98    | 90  | 180                 | 240 | 270 |  |
| 8               | 12         | 12-8     | 90  | 112                 | 203 | 292 |  |
|                 | 16         | 16-8     | 54  | 152                 | 180 | 331 |  |
| 10              | 12         | 12-10    | 60  | 155                 | 270 | 295 |  |
| 11              | 18         | 18-11    | 62  | 119                 | 241 | 340 |  |
| 12              | 14         | 14-12    | 43  | 90                  | -   | -   |  |
| 15              | 14         | 14-15    | 17  | 110                 | 155 | 234 |  |
| 16              | 20         | 20-16    | 238 | 318                 | 333 | 347 |  |
| 18              | 14         | 14-18    | 15  | 90                  | 180 | 270 |  |
| 19              | 14         | 14-19    | 30  | 165                 | 315 | -   |  |
| 21              | 22         | 22-21    | 16  | 135                 | 175 | 349 |  |
|                 | 16         | 16-23    | 158 | 270                 | -   | -   |  |
| 23              | 16         | 16-99    | 66  | 156                 | 223 | 340 |  |
|                 | 20         | 20-24    | 70  | 145                 | 215 | 290 |  |
| 26              | 16         | 16-26    | 60  | -                   | 275 | 338 |  |
| 28              | 18         | 18A28    | -   | -                   | -   | -   |  |
| 30              | 18         | 18-30    | 180 | 193                 | 285 | 350 |  |
|                 | 18         | 18-32    | 85  | 138                 | 222 | 265 |  |
| 32              | 22         | 22-32    | 72  | 145                 | 215 | 288 |  |
|                 | 22         | 22-34    | 62  | 142                 | 218 | 298 |  |
| 36              | 22         | 22-36    | 72  | 144                 | 216 | 288 |  |
| 39              | 20         | 20-39    | 63  | 144                 | 252 | 333 |  |
| 41              | 20         | 20-41    | 45  | 126                 | 225 | -   |  |
|                 | 22         | 22-41    | 39  | 135                 | 264 | -   |  |
| 55              | 22         | 22-55    | 30  | 142                 | 226 | 314 |  |
| 57              | 24         | 24A57    | 90  | 180                 | 270 | 324 |  |
| 61              | 24         | 24-61    | 90  | 180                 | 270 | 324 |  |

Numbers in bold face indicate contact arrangements are not to MIL-C-26482.

Panel Cutouts

Box and Wall Mounting Receptacle

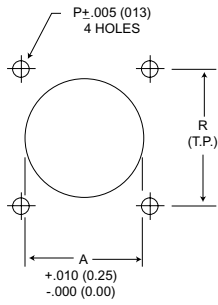

| Shell Size | FLANGE (FRONT MOUNTING) KPT/KPSE |               | MOUNTING HOLE DIA. KPT/KPSE |       |
|------------|----------------------------------|---------------|-----------------------------|-------|
|            | A Dia.                           | R             | P ±.005                     | Screw |
| †8         | .618 (15.70)                     | .594 (15.09)  | .125 (3.17)                 | #4    |
| 10         | .735 (18.67)                     | .719 (18.26)  | .125 (3.17)                 | #4    |
| 12         | .859 (21.82)                     | .812 (20.62)  | .125 (3.17)                 | #4    |
| 14         | .985 (25.02)                     | .906 (23.01)  | .125 (3.17)                 | #4    |
| 16         | 1.113 (28.27)                    | .969 (24.61)  | .125 (3.17)                 | #4    |
| 18         | 1.235 (31.37)                    | 1.062 (26.97) | .125 (3.17)                 | #4    |
| 20         | 1.361 (34.57)                    | 1.156 (29.36) | .125 (3.17)                 | #4    |
| 22         | 1.485 (37.72)                    | 1.250 (31.75) | .125 (3.17)                 | #4    |
| 24         | 1.611 (40.92)                    | 1.375 (34.92) | .155 (3.94)                 | #6    |

†Not Available in KPSE connectors.

Jam Nut Receptacle

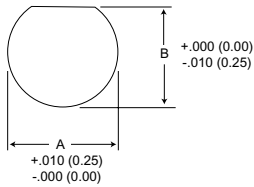

| Shell Size | KPT/KPSE      |               |
|------------|---------------|---------------|
|            | A             | B             |
| †8         | .578 (14.68)  | .540 (13.72)  |
| 10         | .703 (17.86)  | .665 (16.89)  |
| 12         | .890 (22.61)  | .828 (21.02)  |
| 14         | 1.015 (25.78) | .952 (24.18)  |
| 16         | 1.140 (28.96) | 1.076 (27.33) |
| 18         | 1.265 (32.13) | 1.201 (30.51) |
| 20         | 1.390 (35.31) | 1.326 (33.68) |
| 22         | 1.515 (38.48) | 1.451 (36.86) |
| 24         | 1.640 (41.66) | 1.576 (40.03) |

†Not Available in KPSE connectors.

Panel Thickness

Maximum panel thickness dimensions allowable to ensure complete connector operation for the Wall Mounting Receptacle, Box Mounting Receptacle, and Thru-Bulkhead Receptacle.

Wall Mounting and Box Mounting Receptacle

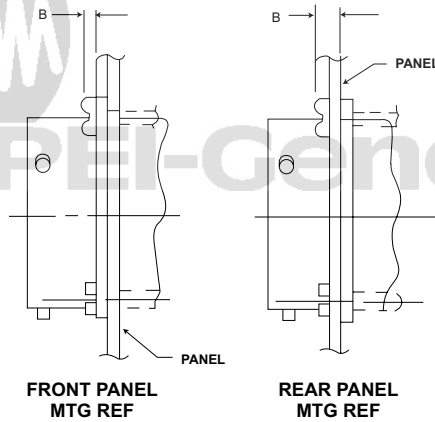

| Size | B Max       |
|------|-------------|
| 8    | .087 (2.21) |
| 10   |             |
| 12   |             |
| 14   |             |
| 16   |             |
| 18   | .212 (5.38) |
| 20   |             |
| 22   |             |
| 24   |             |

Thru-Bulkhead Receptacle

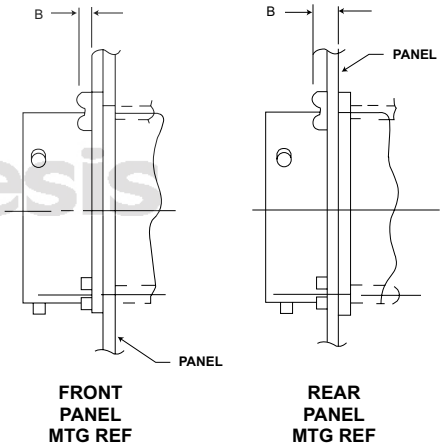

| Size | B Max panel and screw head |
|------|----------------------------|
| 8    | .218 (5.54)                |
| 10   |                            |
| 12   |                            |
| 14   |                            |
| 16   |                            |
| 18   | .334 (8.74)                |
| 20   |                            |
| 22   |                            |
| 24   |                            |

## Dummy Receptacles

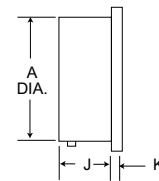
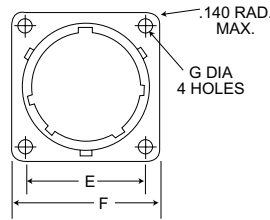
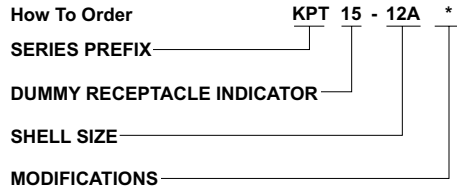

NOTE: For MS Version and additional finishes see PV catalog.

**SERIES PREFIX**  
KPT - ITT Cannon Prefix

**SHELL SIZE**  
8 thru 24

**MODIFICATIONS**  
None - Olive drab chromate over cadmium

| Shell Size | A<br>± .003 (.08) | E<br>Basic    | F<br>Max.     | G<br>± .005 (.13) | J<br>+.031 (.79)<br>-.000 (.00) | K<br>± .016 (.41) |
|------------|-------------------|---------------|---------------|-------------------|---------------------------------|-------------------|
| 8          | .471 (11.96)      | .594 (15.09)  | .828 (21.03)  | .120 (3.05)       | .412 (10.46)                    | .062 (1.57)       |
| 10         | .588 (14.94)      | .719 (18.26)  | .954 (24.23)  | .120 (3.05)       | .412 (10.46)                    | .062 (1.57)       |
| 12         | .748 (19.00)      | .812 (20.62)  | 1.047 (26.60) | .120 (3.05)       | .412 (10.46)                    | .062 (1.57)       |
| 14         | .873 (22.17)      | .906 (23.01)  | 1.141 (28.98) | .120 (3.05)       | .412 (10.46)                    | .062 (1.57)       |
| 16         | .998 (25.35)      | .969 (24.61)  | 1.234 (31.34) | .120 (3.05)       | .412 (10.46)                    | .062 (1.57)       |
| 18         | 1.123 (28.52)     | 1.157 (26.97) | 1.328 (33.73) | .120 (3.05)       | .462 (11.73)                    | .062 (1.57)       |
| 20         | 1.248 (31.70)     | 1.156 (23.96) | 1.453 (36.91) | .120 (3.05)       | .556 (14.12)                    | .094 (2.39)       |
| 22         | 1.373 (34.87)     | 1.250 (31.75) | 1.578 (40.08) | .120 (3.05)       | .556 (14.12)                    | .094 (2.39)       |
| 24         | 1.498 (38.05)     | 1.375 (34.93) | 1.703 (43.26) | .147 (3.73)       | .589 (14.96)                    | .094 (2.39)       |

## Protective Caps

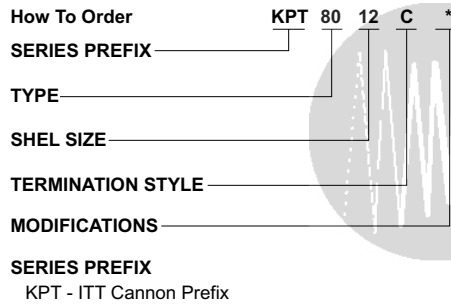

80 - cap for plugs

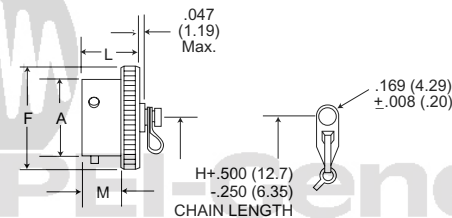

81 - cap for receptacle

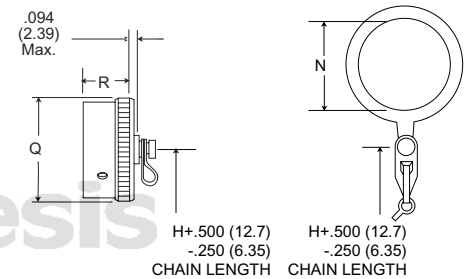

**TYPE**  
80 - Plug Cap  
81 - Receptacle Cap

**SHELL SIZE**  
8 thru 24

**TERMINATION STYLE**  
C - Sash Chain  
N - Sash Chain with Ring (81 type only)

NOTE: For MS version and additional finishes see PV catalog.  
(N Style use Primarily for Jam Nut Receptacle)

| Shell Size | A<br>± .003 (.08) | F<br>Max.     | H              | L<br>Max.    | M<br>+.031 (.79)<br>-.000 (.00) | N<br>Min.     | Q<br>Max.     | R<br>Max.    |
|------------|-------------------|---------------|----------------|--------------|---------------------------------|---------------|---------------|--------------|
| 8          | .471 (11.96)      | .719 (18.26)  | 3.000 (76.20)  | .562 (14.27) | .368 (9.35)                     | .578 (14.68)  | .734 (18.64)  | .562 (14.27) |
| 10         | .588 (14.94)      | .844 (21.44)  | 3.000 (76.20)  | .562 (14.27) | .368 (9.35)                     | .703 (17.86)  | .859 (21.82)  | .562 (14.27) |
| 12         | .748 (19.00)      | 1.000 (25.40) | 3.500 (88.90)  | .562 (14.27) | .368 (9.35)                     | .891 (22.63)  | 1.000 (24.40) | .562 (14.27) |
| 14         | .873 (22.17)      | 1.125 (28.58) | 3.500 (88.90)  | .562 (14.27) | .368 (9.35)                     | 1.016 (25.81) | 1.125 (28.58) | .562 (14.27) |
| 16         | .998 (25.35)      | 1.250 (31.75) | 3.500 (88.90)  | .562 (14.27) | .368 (9.35)                     | 1.141 (28.98) | 1.250 (31.75) | .562 (14.27) |
| 18         | 1.123 (28.52)     | 1.375 (34.93) | 3.500 (88.90)  | .562 (14.27) | .368 (9.35)                     | 1.266 (32.16) | 1.375 (34.93) | .562 (14.27) |
| 20         | 1.248 (31.70)     | 1.500 (38.10) | 4.000 (101.60) | .625 (15.88) | .430 (10.92)                    | 1.391 (35.33) | 1.500 (38.10) | .562 (14.27) |
| 22         | 1.373 (34.87)     | 1.625 (41.26) | 4.000 (101.60) | .625 (15.88) | .430 (10.92)                    | 1.516 (38.51) | 1.625 (41.26) | .562 (14.27) |
| 24         | 1.498 (38.05)     | 1.750 (44.45) | 4.000 (101.60) | .658 (16.71) | .463 (11.76)                    | 1.641 (41.68) | 1.750 (44.45) | .602 (15.29) |

## MATERIALS AND FINISHES

| KPT            |  |
|----------------|--|
| Protective Cap | aluminum alloy, olive drab finish per QQ-P-416 |
| Sash Chain     | stainless steel                                |
| Ring/Rivet     | stainless steel                                |
| Gasket         | polychloroprene                                |

## MIL-C-26482 Specifications

The following excerpts are some of the parameter requirements of the MIL-C-26482 specification.

| Test Description                                | Paragraph Reference | Requirements   |              |                |                |            |                     |    |      |      |      |      |   |   |   |    |    |   |    |    |   |    |    |   |    |    |   |    |    |   |    |    |   |    |    |   |    |    |   |  |  |  |
|---|---------------------|--|--------------|----------------|----------------|------------|---------------------|----|------|------|------|------|---|---|---|----|----|---|----|----|---|----|----|---|----|----|---|----|----|---|----|----|---|----|----|---|----|----|---|--|--|--|
| <b>Contact Retention</b>                        | 4.6.32.1            | After preloading to 3 pounds maximum, the force shall be applied at a rate of approximately 1 pound per second and maintained at full load for 5-10 seconds. No damage to contacts or insert shall result nor shall the contacts be dislocated from their normal position in the connector more than 0.012 inch under give-load for KPSE and within 1 minute after the load is removed for KPT.  |              |                |                |            |                     |    |      |      |      |      |   |   |   |    |    |   |    |    |   |    |    |   |    |    |   |    |    |   |    |    |   |    |    |   |    |    |   |  |  |  |
|   |                     | <table border="1"> <thead> <tr> <th>Contact Size</th> <th>20</th> <th>16</th> <th>12</th> </tr> </thead> <tbody> <tr> <td>Load in Pounds Min.</td> <td>15</td> <td>25</td> <td>25</td> </tr> </tbody> </table>   | Contact Size | 20             | 16             | 12         | Load in Pounds Min. | 15 | 25   | 25   |      |      |   |   |   |    |    |   |    |    |   |    |    |   |    |    |   |    |    |   |    |    |   |    |    |   |    |    |   |  |  |  |
| Contact Size                                    | 20                  | 16   | 12           |                |                |            |                     |    |      |      |      |      |   |   |   |    |    |   |    |    |   |    |    |   |    |    |   |    |    |   |    |    |   |    |    |   |    |    |   |  |  |  |
| Load in Pounds Min.                             | 15                  | 25   | 25           |                |                |            |                     |    |      |      |      |      |   |   |   |    |    |   |    |    |   |    |    |   |    |    |   |    |    |   |    |    |   |    |    |   |    |    |   |  |  |  |
| <b>Contact Insertion/Extraction (KPSE only)</b> | 4.6.11              | When using the proper insertion and extraction tools the forces required to insert or extract the contact shall not exceed 20 lbs. Connectors shall be less endbell.   |              |                |                |            |                     |    |      |      |      |      |   |   |   |    |    |   |    |    |   |    |    |   |    |    |   |    |    |   |    |    |   |    |    |   |    |    |   |  |  |  |
| <b>Coupling Torque</b>                          | 4.6.3               | For qualification testing, mating halves shall be coupled and uncoupled, measuring the torques necessary. The torques required to couple and uncouple mating connectors halves shall fall within the limits specified as follows:  |              |                |                |            |                     |    |      |      |      |      |   |   |   |    |    |   |    |    |   |    |    |   |    |    |   |    |    |   |    |    |   |    |    |   |    |    |   |  |  |  |
|   |                     | <table border="1"> <thead> <tr> <th rowspan="2">Shell Size</th> <th colspan="2">Torque lb./in.</th> <th rowspan="2">Shell Size</th> <th colspan="2">Torque lb./in.</th> </tr> <tr> <th>Max.</th> <th>Min.</th> <th>Max.</th> <th>Min.</th> </tr> </thead> <tbody> <tr> <td>8</td> <td>8</td> <td>1</td> <td>18</td> <td>28</td> <td>4</td> </tr> <tr> <td>10</td> <td>12</td> <td>1</td> <td>20</td> <td>32</td> <td>6</td> </tr> <tr> <td>12</td> <td>16</td> <td>2</td> <td>22</td> <td>36</td> <td>7</td> </tr> <tr> <td>14</td> <td>20</td> <td>4</td> <td>24</td> <td>44</td> <td>7</td> </tr> <tr> <td>16</td> <td>24</td> <td>4</td> <td></td> <td></td> <td></td> </tr> </tbody> </table>  | Shell Size   | Torque lb./in. |                | Shell Size | Torque lb./in.      |    | Max. | Min. | Max. | Min. | 8 | 8 | 1 | 18 | 28 | 4 | 10 | 12 | 1 | 20 | 32 | 6 | 12 | 16 | 2 | 22 | 36 | 7 | 14 | 20 | 4 | 24 | 44 | 7 | 16 | 24 | 4 |  |  |  |
| Shell Size                                      | Torque lb./in.      |  |              | Shell Size     | Torque lb./in. |            |                     |    |      |      |      |      |   |   |   |    |    |   |    |    |   |    |    |   |    |    |   |    |    |   |    |    |   |    |    |   |    |    |   |  |  |  |
|   | Max.                | Min.   | Max.         |                | Min.           |            |                     |    |      |      |      |      |   |   |   |    |    |   |    |    |   |    |    |   |    |    |   |    |    |   |    |    |   |    |    |   |    |    |   |  |  |  |
| 8   | 8                   | 1  | 18           | 28             | 4              |            |                     |    |      |      |      |      |   |   |   |    |    |   |    |    |   |    |    |   |    |    |   |    |    |   |    |    |   |    |    |   |    |    |   |  |  |  |
| 10  | 12                  | 1  | 20           | 32             | 6              |            |                     |    |      |      |      |      |   |   |   |    |    |   |    |    |   |    |    |   |    |    |   |    |    |   |    |    |   |    |    |   |    |    |   |  |  |  |
| 12  | 16                  | 2  | 22           | 36             | 7              |            |                     |    |      |      |      |      |   |   |   |    |    |   |    |    |   |    |    |   |    |    |   |    |    |   |    |    |   |    |    |   |    |    |   |  |  |  |
| 14  | 20                  | 4  | 24           | 44             | 7              |            |                     |    |      |      |      |      |   |   |   |    |    |   |    |    |   |    |    |   |    |    |   |    |    |   |    |    |   |    |    |   |    |    |   |  |  |  |
| 16  | 24                  | 4  |              |                |                |            |                     |    |      |      |      |      |   |   |   |    |    |   |    |    |   |    |    |   |    |    |   |    |    |   |    |    |   |    |    |   |    |    |   |  |  |  |
| <b>Durability</b>                               | 4.6.17              | Connector halves shall be mated and unmated 500 times at a rate of 200 ± 100 cycles per hour. The test may be performed by hand or by mechanical means, but the coupling ring shall be operated as in normal service. Failure to complete this test because of mechanical malfunction shall be cause for rejection.  |              |                |                |            |                     |    |      |      |      |      |   |   |   |    |    |   |    |    |   |    |    |   |    |    |   |    |    |   |    |    |   |    |    |   |    |    |   |  |  |  |
| <b>Insert Retention</b>                         | 4.6.29              | Connectors with the endbells and grommets (if possible) removed shall be subjected to a 75 psi load on the insulator in both directions. The load shall be applied at a rate of 10lb/sec. and held for 5 to 10 secs. Insulators shall not be dislogged from their original position.   |              |                |                |            |                     |    |      |      |      |      |   |   |   |    |    |   |    |    |   |    |    |   |    |    |   |    |    |   |    |    |   |    |    |   |    |    |   |  |  |  |
| <b>Insulation Resistance</b>                    | 4.6.7.1             | On unmated connectors at 25°C±3°C a potential of 500 VDC ± 10% shall be applied between all, but not more than 6, pairs of adjacent contacts and between all, but not more than 6, contacts and the shell. Failure to meet a minimum requirement of 5,000 megohms shall be cause for rejection.  |              |                |                |            |                     |    |      |      |      |      |   |   |   |    |    |   |    |    |   |    |    |   |    |    |   |    |    |   |    |    |   |    |    |   |    |    |   |  |  |  |
| <b>Vibration</b>                                | 4.6.21              | Wired, mated connectors shall be subjected to the vibration test of MIL-STD-1344, Method 2005, Test Condition II. Receptacles shall be mounted on the vibration fixture by normal means. All contacts shall be wired in a series circuit and 100 max. milliamperes of current shall be allowed to flow through the series circuit during vibration. Suitable means shall be employed to monitor the current flow and to indicate any discontinuity of more than 10 microseconds. The wire bundle shall be clamped to nonvibrating points at least 8 inches from the rear of the connector. Current discontinuity of 10 microsecond or more, disengagement of the mated connectors, evidence of cracking, breaking, or loosening of parts shall be cause for rejection. |              |                |                |            |                     |    |      |      |      |      |   |   |   |    |    |   |    |    |   |    |    |   |    |    |   |    |    |   |    |    |   |    |    |   |    |    |   |  |  |  |
| <b>Shock</b>                                    | 4.6.23              | Wired, mated connectors shall be subjected to one shock in each direction in each of three mutually perpendicular axes. The pulse shall be approximate half sine wave of 50g±15% magnitude with a duration of 11 ± 1 milliseconds. Receptacles shall be mounted on a shock fixture by normal means. All contacts shall be wired in a series circuit and 90-110 ma. of current shall flow through the series circuit during shock. Suitable means shall be employed to Monitor the current flow and to indicate any discontinuity of more than 10 microseconds. Current discontinuity of 10 microseconds or more, disengagement of the mated connectors, evidence of cracking, breaking, or loosening of parts shall be cause for rejection.                            |              |                |                |            |                     |    |      |      |      |      |   |   |   |    |    |   |    |    |   |    |    |   |    |    |   |    |    |   |    |    |   |    |    |   |    |    |   |  |  |  |
| <b>Thermal Shock</b>                            | 4.6.12              | Wired, unmated plug and receptacle shall be subjected to 5 cycles of hot and cold temperatures. Maximum temperature shall be + 125°C and the minimum shall be -55°C. Duration at each temperature extreme shall be 1/2 hour minimum. Cracking, breaking or loosening of parts shall be cause for rejection.  |              |                |                |            |                     |    |      |      |      |      |   |   |   |    |    |   |    |    |   |    |    |   |    |    |   |    |    |   |    |    |   |    |    |   |    |    |   |  |  |  |
| <b>Humidity</b>                                 | 4.6.25              | The connectors shall be subjected to varying humidity, 50% to 95%, conditions for a period of 10 days KPSE or 20 days KPT. The insulation resistance shall not be less than 100 megohms.   |              |                |                |            |                     |    |      |      |      |      |   |   |   |    |    |   |    |    |   |    |    |   |    |    |   |    |    |   |    |    |   |    |    |   |    |    |   |  |  |  |
| <b>Air Leakage (KPT Only)</b>                   | 4.6.15.1            | A 30 psi pressure differential shall be applied across the connector for 30 minutes. The leak rate, in either direction, shall be no greater than 1 atmosphere cubic inch per hour (4.55 X 10 <sup>-6</sup> cm <sup>3</sup> /S) at - 67°F (- 55°C).  |              |                |                |            |                     |    |      |      |      |      |   |   |   |    |    |   |    |    |   |    |    |   |    |    |   |    |    |   |    |    |   |    |    |   |    |    |   |  |  |  |
| <b>Salt Spray (Corrosion)</b>                   | 4.6.19              | Unmated and wired connectors shall be subject to a salt fog for 48 hours. These shall be no exposure of base metal, the connector shall be functional and meet the contact resistance requirement.   |              |                |                |            |                     |    |      |      |      |      |   |   |   |    |    |   |    |    |   |    |    |   |    |    |   |    |    |   |    |    |   |    |    |   |    |    |   |  |  |  |
| <b>Fluid Immersion</b>                          | 4.6.27              | At least one connector, unmated and wired, shall be immersed in each fluid for a period of 20 hours then dried at room conditions for hour. Connectors shall be able to mate and meet the coupling torque requirements.<br>a) Hydraulic Fluid per MIL-H-5606, b) Lubricating Oil per MIL-L-7808  |              |                |                |            |                     |    |      |      |      |      |   |   |   |    |    |   |    |    |   |    |    |   |    |    |   |    |    |   |    |    |   |    |    |   |    |    |   |  |  |  |

**Tooling, Crimp**

M22520/1-01 CRIMP TOOL  
M22520/1-02 Turret



CBT-520/530

**Tooling, Insertion/Extraction**



KPSE Insertion



KPSE Extraction

| Contact Size |            |
|--------------|------------|
| 20           | MS24256A20 |
| 16           | MS24256A16 |

| Contact Size |            |
|--------------|------------|
| 20           | MS24256R20 |
| 16           | MS24256R16 |

**Contacts**

| Contact Size/Type | Military Part Number | Color Bands |        |        | ITT Cannon Part Number |
|-------------------|----------------------|-------------|--------|--------|------------------------|
|                   |                      | 1st         | 2nd    | 3rd    |                        |
| 20 Socket         | M39029/32-259        | Red         | Green  | White  | 031-9074-002           |
| 20 Pin            | M39029/31-240        | Red         | Yellow | Black  | 030-9036-000           |
| 16 Socket         | M39029/32-247        | Red         | Yellow | Violet | 031-9095-003           |
| 16 Pin            | M39029/31-228        | Red         | Red    | Grey   | 030-9032-003           |

#20

Contacts for printed circuit applications also available

**Wire Hole Fillers/Grommets Sealing Plugs**

| Contact Size | Part Number  |           | Color Code |
|--------------|--------------|-----------|------------|
|              | Cannon       | Military  |            |
| 20           | 225-1012-000 | MS3187A20 | Red        |
| 16           | 225-1011-000 | MS3187-16 | Blue       |

## KPSE Assembly Instructions

| Contact Size | Wire Size AWG | Strip Insulation |
|--------------|---------------|------------------|
| 20           | #20-#24       | 3/16"            |
| 16           | #16-#20       | 1/4"             |

Right

Wrong



### CRIMPING CONTACTS

- Strip wires according to the table above taking care not to cut or nick strands.
- Insert stripped wire into contact crimp pot. Wire must be visible thru inspection hole.
- Using correct crimp tool and locator select proper crimp setting for wire size to be crimped; cycle the tool once to be sure the indentors are open. Insert contact and wire into locator. Squeeze tool handles firmly and completely to insure a proper crimp. The tool will not release unless the crimp indentors in the tool head have been fully actuated. Release crimped contact and wire from tool. Be certain the wire is visible thru inspection hole in contact.  
**CAUTION: Check that none of the contacts are bent or damaged in any way after crimping.**

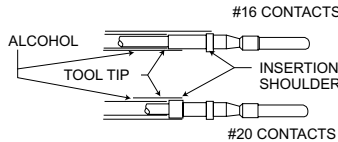
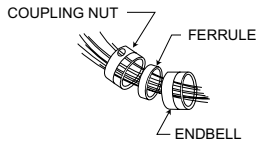

### CONTACT INSERTION

- Remove hardware from plug and receptacle. Slide hardware over wire bundle in proper order for reassembly.
- Use the proper contact insertion tool and slide the tool over the terminal end of the contact. The size 16 contact lies in the tool and the tool tip butts against the contact shoulder. The rear, or insulation support of the size 20 contact butts against an internal shoulder in the tool tip.  
**NOTE: Apply a small amount of isopropyl alcohol to the insertion tool tip while installing contacts.**
- Beginning from center cavity and working outwards in a circular pattern, insert wired contacts into rear of connector by hand until the front of the contact shoulder is no more than 1/8" from the grommet. Holding the connector horizontally, position tool behind contact. Push tool straight into contact cavity until contact snaps into position. A light pull on wire will assure that contact is locked securely. Repeat for remaining contacts.



# PEI-Genesis

| Size           | Torque in/lbs. |
|----------------|----------------|
| 8,10,12 and 14 | 10-15          |
| 16 and 18      | 15-25          |
| 20,22 and 24   | 25-35          |

- Use contacts and grommet sealing plugs to fill any empty cavities.

### COMPLETION

- Check face of plug or receptacle for proper contact installation.
- Using mating connector with contacts installed, mate both connector halves together.
- Assemble ferrule over the grommet by hand as far as possible.
- Assemble endbell over ferrule and loosely tighten endbell. Partially loosen (1/4 turn) and retighten to recommended torque limits.



2nd Index Line  
Socket Contacts

1st Index Line  
Pin Contacts



### CONTACT EXTRACTION

- Slide hardware back over wire bundle. Using proper extraction tool or extraction end of proper insertion/extraction tool, proceed as follows:  
KPSE: There are two lines on the clip sleeve which are vital to the contact removal process. The first index line is used for removing pin contacts while the second index line is for removing socket contacts. Carefully place the tool tip over the contact to be extracted until the tool tip touches the insulator face. Carefully rotate the tool until the index line is slightly below the insulator face. Keep an even pressure against tool body; push plunger forward with thumb and index finger, and push the contact out through the clip. Carefully remove extraction tool from connector. Pull wire by hand to complete the removal of the contact.

How to Order - Special Termination Connectors



|      |    |   |    |   |    |   |   |
|------|----|---|----|---|----|---|---|
| KPT  | 03 | - | 18 | - | 32 | P | W |
| KPT  | 04 | - | 18 | - | 32 | P | W |
| KPT  | 05 | - | 18 | - | 32 | P | W |
| KPSE | 03 | - | 18 | - | 32 | P | W |
| KPSE | 04 | - | 18 | - | 32 | P | W |
| KPSE | 05 | - | 18 | - | 32 | P | W |

PREFIX \_\_\_\_\_

SHELL STYLE \_\_\_\_\_

DASH (No Class required, less rear termination) \_\_\_\_\_

SHELL SIZE \_\_\_\_\_

CONTACT ARRANGEMENT \_\_\_\_\_

CONTACT TYPE \_\_\_\_\_

P - PIN

S - Socket

ALTERNATE INSERT POSITION \_\_\_\_\_

Contact ITT Cannon for additional Information

Solder Type KPT03/04/05-Supplied less endbell, ferrule and grommet.

KPT03

KPT04



KPT05



Solder Type KPSE03/04/05-Supplied less endbell, ferrule.

KPSE03

KPSE04



KPSE05



Twist Pull Lanyard Release Coupler Plug

KPT06/KPSE06



|      |   |   |    |   |    |   |   |    |
|------|---|---|----|---|----|---|---|----|
| KPT  | 6 | A | 22 | - | 55 | P | W | 16 |
| KPSE | 6 | E | 22 | - | 55 | S | Z | 16 |

PREFIX \_\_\_\_\_

SHELL STYLE \_\_\_\_\_

SERVICE TYPE \_\_\_\_\_

SHELL SIZE \_\_\_\_\_

CONTACT ARRANGEMENT \_\_\_\_\_

CONTACT TYPE \_\_\_\_\_

POLARIZATION \_\_\_\_\_

MODIFICATION CODE\* \_\_\_\_\_

\*Omit (0) of shell style indication when using this modification code.

16 = Overall length of connector including lanyard to be 6.0 (152.40) ± .125 (3.18) when measured over a 1.0 (25.40) ± .005 (0.13) diameter mandrel.

Printed Circuit Termination

KPT02E

KPT07



## X-ON Electronics

Largest Supplier of Electrical and Electronic Components

*Click to view similar products for [Circular MIL Spec Connector](#) category:*

*Click to view products by [ITT](#) manufacturer:*

Other Similar products are found below :

[89075GULPR](#) [0025-262-542](#) [0025-264-3014](#) [58-570121-04S](#) [0134-213-1208](#) [0134-213-2209](#) [0025-258-000](#) [60-042022-07P](#) [60-042022-19P](#)  
[60-042022-23P](#) [60-042217-10P](#) [0114-201-1278](#) [012-0467-000](#) [602GB06EG24-61SN](#) [0134-201-1207](#) [0134-213-1006](#) [6104-207-2302](#) [6104-](#)  
[208-1902](#) [61-168211-04P](#) [61-168617-10P](#) [6131-202-19149P](#) [6131-204-21149P](#) [6131-208-13149P](#) [6131-209-17149P](#) [6131-210-11149P](#) [6131-](#)  
[211-19149P](#) [6131-216-19149P](#) [6131-259-21149P](#) [6131-259-23149P](#) [6131-265-17149P](#) [6131-265-19149P](#) [CS3100A18-1P-472](#) [CS3100A-36-](#)  
[77P](#) [CS3101A-16-55P](#) [CS3102A-10SL-55P](#) [CS3102A-14S-58P](#) [CS3102A-32-17P](#) [CS3102A32-25S](#) [CS3102C18-4P-472](#)  
[CS3106A10SL3S004](#) [CS3106A-18-73S](#) [CS3108A-14S-52S](#) [CS3108A-28-51S](#) [6162-233-1277](#) [6162-324-1231](#) [M243082296Z](#)  
[M2884010AC1S1](#) [CT0-24-10SC](#) [CT0M20-7PCAU](#) [M28840/17AC1G3](#)