

REV	A1	DATE	2018.04.18	DESCRIPTION	CHANGE THE DRAWING
		DATE	2006.06.10	DESCRIPTION	NEW RELEASE
		DATE	x.xxx±0.15	DESCRIPTION	
		DATE	x.xxx±0.20	DESCRIPTION	
		DATE	x.xxx±0.25	DESCRIPTION	
DRAW NO : A2002WV-XP		General Tolerance		ANGLES	
180° WAFER		Tony Su		Jack Yin	
2.00mm PITCH		Draw By:		Approved:	
Title :		mm		5:1	
CHANGJIANG CONNECTORS CO.,LTD.		Unit		Scale	
CJTcom		Sheet		1 of 1	

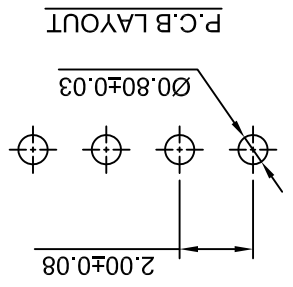
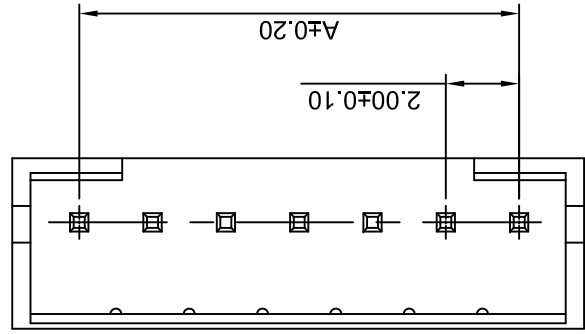
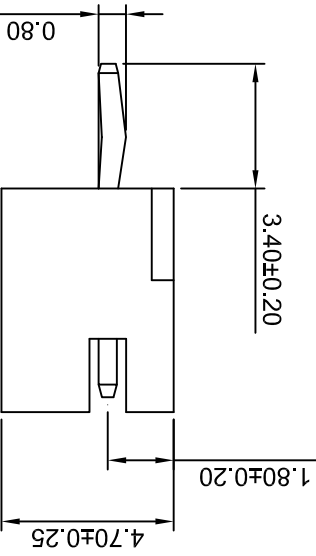
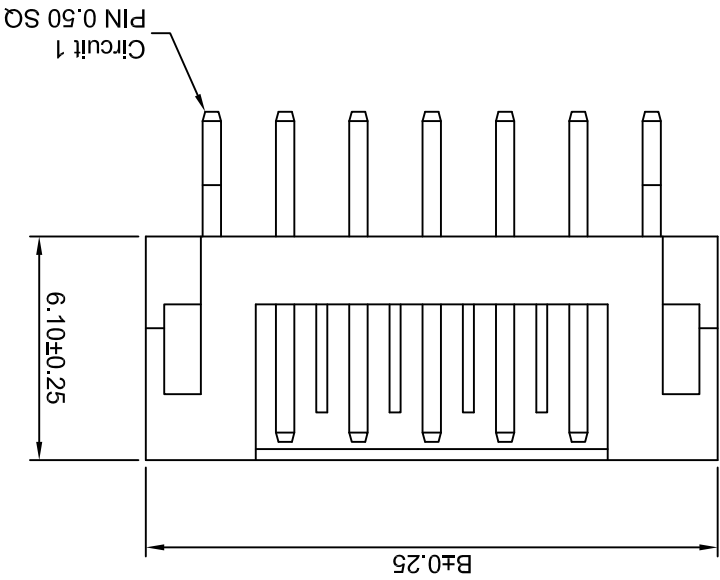

Circuits		A		B	
Dimensions(mm)		A		B	
8P	14.00	14.00	18.00	8P	14.00
7P	12.00	12.00	16.00	7P	12.00
6P	10.00	10.00	14.00	6P	10.00
5P	8.00	8.00	12.00	5P	8.00
4P	6.00	6.00	10.00	4P	6.00
3P	4.00	4.00	8.00	3P	4.00
2P	2.00	2.00	6.00	2P	2.00
Circuits		A		B	
Dimensions(mm)		A		B	
15P	28.00	15P	28.00	15P	28.00
14P	26.00	14P	26.00	14P	26.00
13P	24.00	13P	24.00	13P	24.00
12P	22.00	12P	22.00	12P	22.00
11P	20.00	11P	20.00	11P	20.00
10P	18.00	10P	18.00	10P	18.00
9P	16.00	9P	16.00	9P	16.00

Ordering Information & Dimensions
Pantone Color: 153C~154C
Material: Nylon 66, UL94V-0(Brown)
Pin Material: Brass/Tin over Nickel
Withstanding Voltage: 1000V AC/minute
Insulation Resistance: 100MΩ Min
Contact Resistance: 20mΩ Max
Temperature Range: -40°C ~ +105°C
Voltage Rating: 300V AC, DC
Current Rating: 3A AC, DC

SPECIFICATIONS:

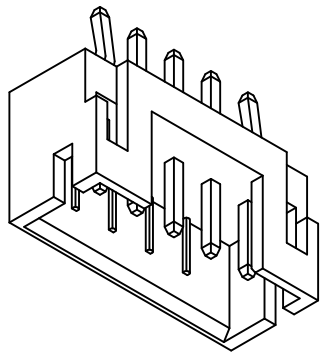

X-ON Electronics

Largest Supplier of Electrical and Electronic Components

Click to view similar products for [Headers & Wire Housings](#) category:

Click to view products by [Changjiang](#) manufacturer:

Other Similar products are found below :

[95000-104TRLF](#) [10135584-644402LF](#) [DF62W-EP2022PCA](#) [95000-106TRLF](#) [DF62W-2022SCA](#) [DF62W-EP2022PC](#) [2203348](#) [DF62W-2022SC](#) [1084018](#) [1029039](#) [1084017](#) [802-10-012-10-002000](#) [1112640](#) [1112639](#) [000-34000](#) [0009482033](#) [0009507031](#) [57102-S06-03LF](#) [57202-S52-04LF](#) [PCN6-15S-2.5E](#) [0039019024](#) [58102-G61-06LF](#) [582553-1](#) [0009508121](#) [0022285053](#) [0050291907](#) [018731A](#) [LY20-4P-DT1-P1E-BR](#) [02.125.8002.8](#) [60101931](#) [60598-1 \(Cut Strip\)](#) [M1625-3R/100](#) [61062-3](#) [61082-181009](#) [636-1427](#) [638009-1](#) [641938-9](#) [641991-4](#) [644168-1](#) [647662-1](#) [65039-019ELF](#) [65817-002LF](#) [65817-015LF](#) [65863-015LF](#) [66207-023LF](#) [67016-026LF](#) [67046-001LF](#) [67095-007LF](#) [67230-005LF](#) [68002-116](#)